

AIR HYDRAULIC CART, AIR-1500-D

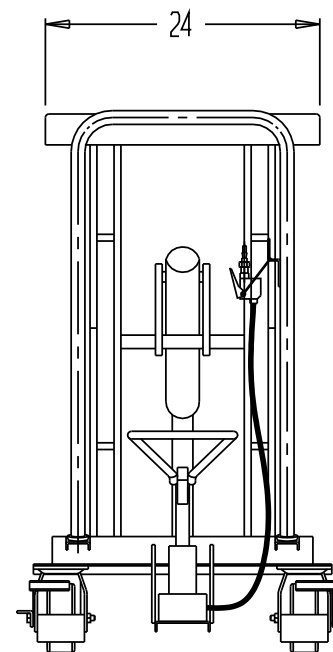
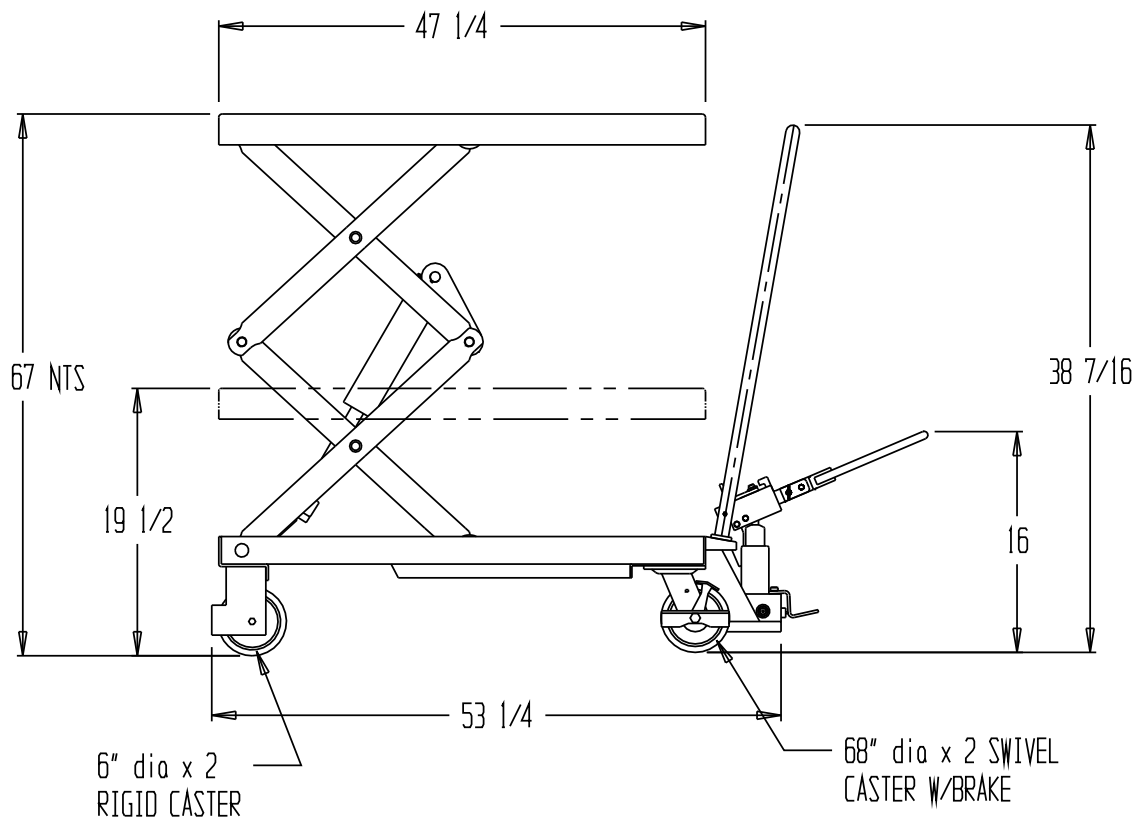

STANDARD FEATURES

MODEL NUMBER: AIR-1500-D
 CAPACITY: 1500 LBS.
 PLATFORM WIDTH: 24"
 PLATFORM LENGTH: 47 1/4"
 PLATFORM RAISED HEIGHT: 67"
 PLATFORM LOWERED HEIGHT: 19 1/2"
 OPERATION: TWO SPEED FOOT PUMP
 OR HAND HELD RECIPROCATING AIR/OIL

SPECIAL FEATURES

NONE

Any additions, deletions or omissions must be corrected on this drawing, as this drawing will be considered all inclusive.

All graphics provided are for reference only. If certain dimensions are critical please verify those dimensions with your salesperson

I, THE UNDERSIGNED, AGREE THAT THE PRODUCT AS REPRESENTED SATISFIES DESIGN & DIMENSION REQUIREMENTS. I ALSO ACKNOWLEDGE MY DUTY TO CONFIRM PRODUCT & INSTALLATION COMPLIANCE WITH ALL APPLICABLE FEDERAL, STATE AND LOCAL REGULATIONS & STANDARDS.
ALL SPECIAL UNITS ARE NON-RETURNABLE
 As drawn As marked
 Signed: _____ Date: _____
 LEAD TIME WILL START UPON RECEIPT OF SIGNED APPROVAL DRAWING

DISTRIBUTOR'S NAME: VESTIL MFG		P.O.#: _
DRAWN BY: _____		W.O.#: _
DATE: _	SCALE: _	SALES: _
REFERENCE: _	QUOTED LEADTIME: _	DRWG./FILE NAME: AIR-1500-D
QUOTE #: _		