

ALUMINUM TREAD PLATE PORTABLE TOOL BOX - APTS-2460-CF-FD

APPROX WEIGHT: 150.52 lbs.  
DOES NOT INCLUDE WEIGHT OF POWER OR PACKAGING!!!

\*\*\* ANY ADDITIONS, DELETIONS, OR OMISSIONS MUST BE CORRECTED ON THIS DRAWING AS THIS DRAWING WILL BE CONSIDERED ALL INCLUSIVE \*\*\*

ALL GRAPHICS PROVIDED ARE FOR REFERENCE ONLY. IF CERTAIN DIMENSIONS ARE CRITICAL PLEASE VERIFY THOSE DIMENSIONS WITH YOUR SALESPERSON

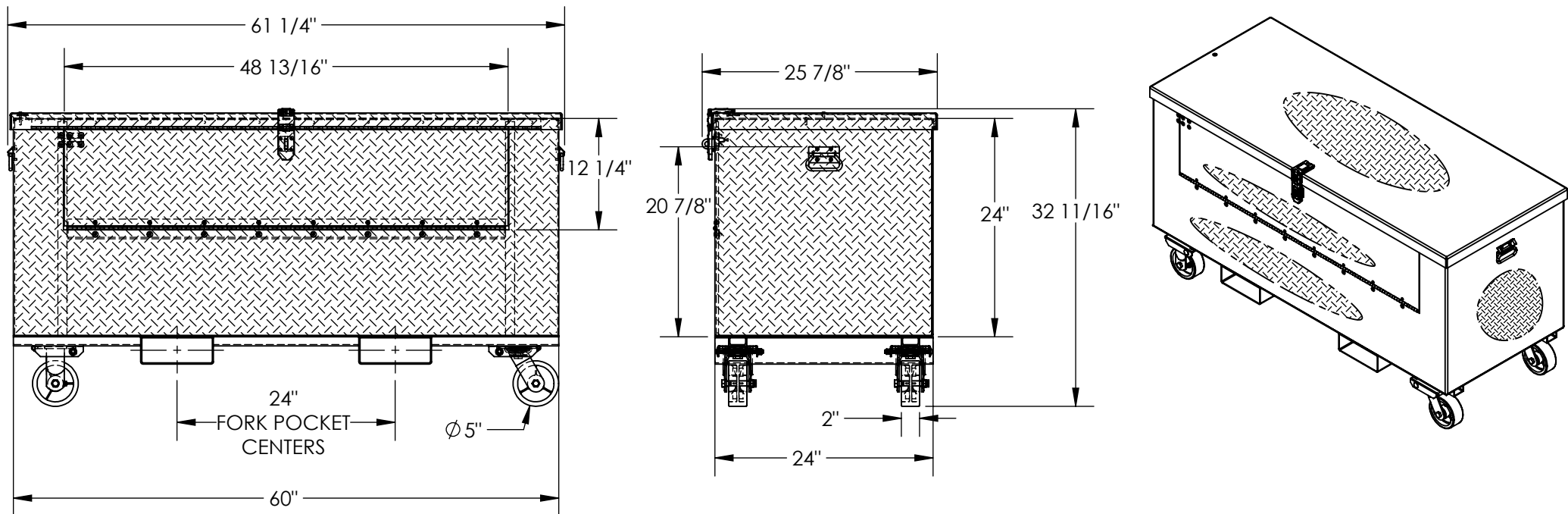

STANDARD FEATURES

MODEL NUMBER IS APTS-2460-CF-FD  
OVERALL WIDTH IS 61 1/4"  
USABLE WIDTH IS 60"  
OVERALL DEPTH IS 25 7/8"  
USABLE DEPTH IS 24"  
OVERALL HEIGHT IS 32 11/16"  
USABLE HEIGHT IS 24"  
MAX CAPACITY IS 2500 LBS.  
24" FORK POCKET CENTERS  
CASTERS ARE 5" x 2" POLY ON STEEL  
2 SWIVEL, 2 RIGID  
FOLD-DOWN FRONT DOOR  
12 1/4" HIGH BY 48 13/16" WIDE

SPECIAL FEATURES

NONE

DIMENSION TOLERANCE ± 1/4"

APPROVAL	I, THE UNDERSIGNED, AGREE THAT THE PRODUCT AS REPRESENTED SATISFIES DESIGN AND DIMENSION REQUIREMENTS. I ALSO ACKNOWLEDGE MY DUTY TO CONFIRM PRODUCT AND INSTALLATION COMPLIANCE WITH ALL APPLICABLE FEDERAL, STATE AND LOCAL REGULATIONS AND STANDARDS.	
	<b>ANY MODIFIED UNITS ARE NON-RETURNABLE</b>	
	[ ] As drawn [ ] As marked	
	Signed: _____ Date: _____	
Printed Name: _____		
LEAD TIME WILL START UPON RECEIPT OF SIGNED APPROVAL DRAWING		

FOR INTERNAL USE ONLY PROJECT SIGN OFF		DISTRIBUTOR'S NAME:		P.O.#	
		VESTIL MANUFACTURING		X	
SALES		DRAWN BY:	B.NOTHNAGEL	DATE:	11/12/2015
ENG.		REFERENCE:	X	SCALE:	1:16
FAB.		QUOTED LEAD TIME:	X	QUOTE #	X
POWER					FILE NAME:
					41-007-024-003