

APPROX WEIGHT: 112.54 lbs.
DOES NOT INCLUDE WEIGHT OF POWER OR PACKAGING!!!

ADJUSTABLE STEP-MATE STANDS - MODEL: ASP-72

*** ANY ADDITIONS, DELETIONS, OR OMISSIONS MUST BE CORRECTED ON THIS DRAWING AS THIS DRAWING WILL BE CONSIDERED ALL INCLUSIVE ***

ALL GRAPHICS PROVIDED ARE FOR REFERENCE ONLY. IF CERTAIN DIMENSIONS ARE CRITICAL PLEASE VERIFY THOSE DIMENSIONS WITH YOUR SALESPERSON

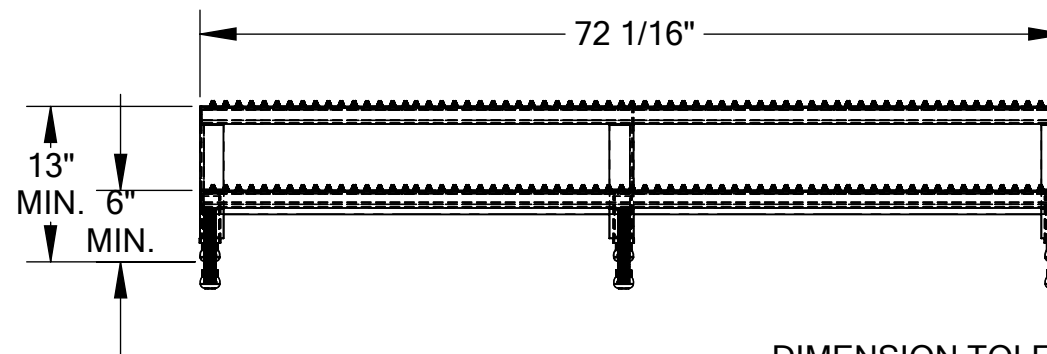
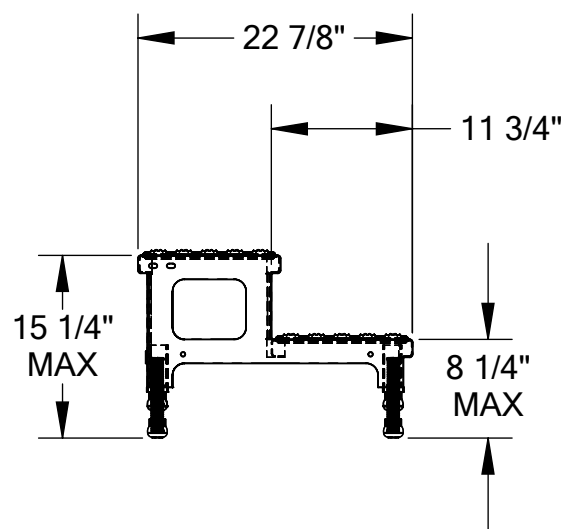
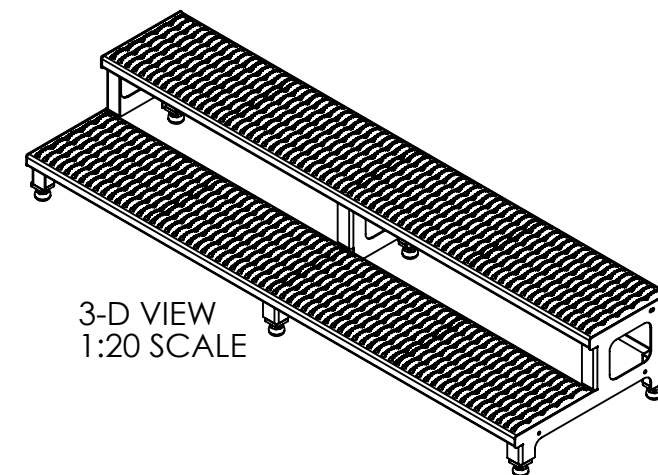

DIMENSION TOLERANCE $\pm 1/4$ "

STANDARD FEATURES

MODEL NUMBER IS ASP-72

CAPACITY: 500 LBS

OVERALL WIDTH: 72 1/16"

OVERALL LENGTH: 11 3/4"

BOTTOM STEP HEIGHT: MIN. 6", MAX. 8 1/4"

TOP STEP HEIGHT: MIN. 13", MAX. 15 1/4"

STEPS:

-SERRATED STEEL 11 3/4" DEEP

LEGS:

-ADJUSTABLE

-ANTI-SLIP TIPS

TOUGH BAKED IN POWDER

COATED YELLOW FINISH

SPECIAL FEATURES

NONE

APPROVAL

I, THE UNDERSIGNED, AGREE THAT THE PRODUCT AS REPRESENTED SATISFIES DESIGN AND DIMENSION REQUIREMENTS. I ALSO ACKNOWLEDGE MY DUTY TO CONFIRM PRODUCT AND INSTALLATION COMPLIANCE WITH ALL APPLICABLE FEDERAL, STATE AND LOCAL REGULATIONS AND STANDARDS.
UNITS REQUIRING APPROVAL DRAWINGS OR MODIFIED ARE NON-RETURNABLE

☐ As drawn ☐ As marked

Signed: _____ Date: _____

Printed Name: _____

LEAD TIME WILL START UPON RECEIPT OF SIGNED APPROVAL DRAWING

DISTRIBUTOR'S NAME:

VESTIL MANUFACTURING

P.O.#

X

W.O.#

X

DRAWN BY: W. STALEY

DATE: 12/30/08

SALES: X

REFERENCE: X

SCALE: 1:16

FILE NAME:

QUOTED LEAD TIME: X

QUOTE # X

14-007-053