

STACKABLE BAR CRADLE - CRAD-25-72

APPROX WEIGHT: 105.86 lbs.
DOES NOT INCLUDE WEIGHT OF POWER OR PACKAGING!!!

*** ANY ADDITIONS, DELETIONS, OR OMISSIONS MUST BE CORRECTED ON THIS DRAWING AS THIS DRAWING WILL BE CONSIDERED ALL INCLUSIVE ***

ALL GRAPHICS PROVIDED ARE FOR REFERENCE ONLY. IF CERTAIN DIMENSIONS ARE CRITICAL PLEASE VERIFY THOSE DIMENSIONS WITH YOUR SALESPERSON

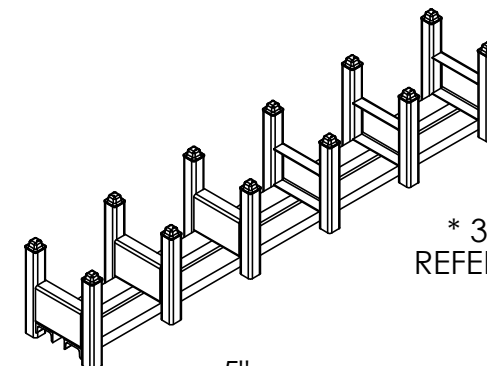
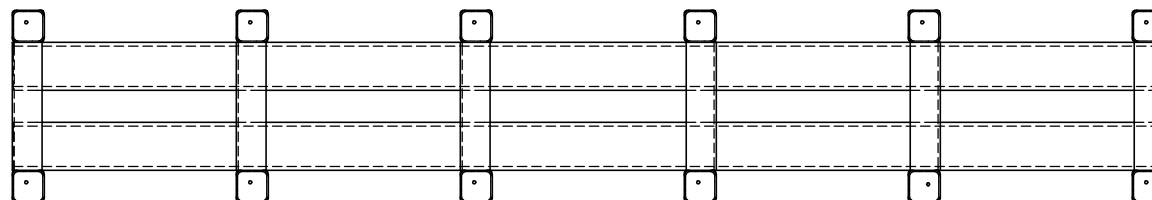

* 3D VIEW FOR
REFERENCE ONLY *

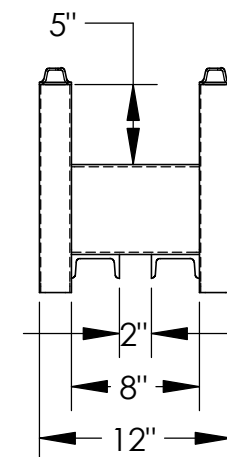
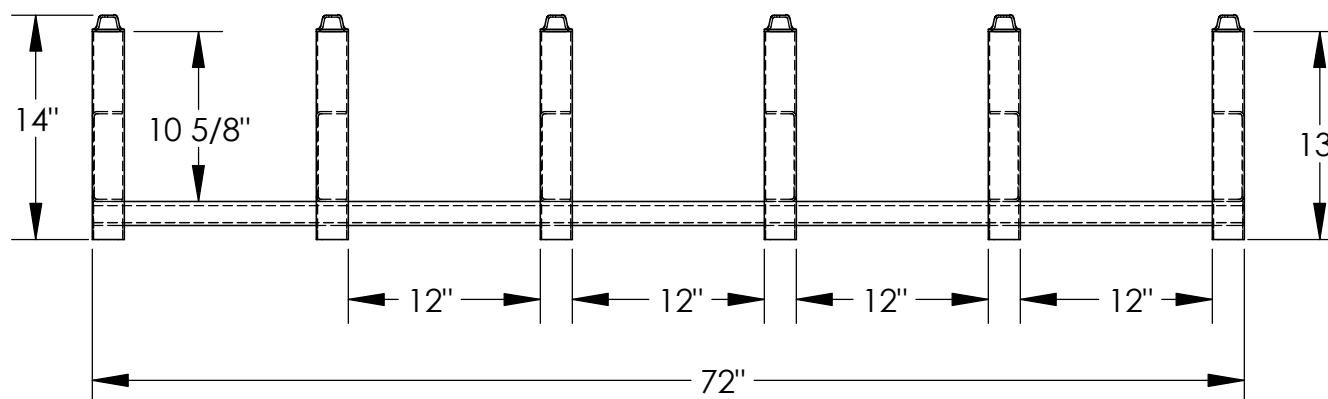

STANDARD FEATURES

MODEL # - CRAD-25-72
CAPACITY OF EACH- 1,250 LBS.
CAPACITY PER PAIR- 2,500 LBS. (UNITS ARE SOLD EACH)
WIDTH - 12"
LENGTH - 72"
OVERALL HEIGHT - 14"
INSIDE HEIGHT- 10 5/8"

SPECIAL FEATURES

NONE

DIMENSION TOLERANCE $\pm 1/4"$

APPROVAL

I, THE UNDERSIGNED, AGREE THAT THE PRODUCT AS REPRESENTED SATISFIES DESIGN AND DIMENSION REQUIREMENTS. I ALSO ACKNOWLEDGE MY DUTY TO CONFIRM PRODUCT AND INSTALLATION COMPLIANCE WITH ALL APPLICABLE FEDERAL, STATE AND LOCAL REGULATIONS AND STANDARDS.

ANY MODIFIED UNITS ARE NON-RETURNABLE

[] As drawn [] As marked

Signed: _____ Date: _____

Printed Name: _____

LEAD TIME WILL START UPON RECEIPT OF SIGNED APPROVAL DRAWING

FOR INTERNAL USE ONLY
PROJECT SIGN OFF

SALES	
ENG.	
FAB.	
POWER	

DISTRIBUTOR'S NAME:

VESTIL MANUFACTURING

P.O.# X

W.O.# X

DRAWN BY: KY

DATE: 01/28/2005

SALES: X

REFERENCE: X

SCALE: 1:12

FILE NAME:

QUOTED LEAD TIME: X

QUOTE # X

31-007-043