

# TRUCK STOP- GRAY: CS-TB96-G

APPROXIMATE WEIGHT IS: 1291.20 lbs.

\*\*\* ANY ADDITIONS, DELETIONS, OR OMISSIONS MUST BE CORRECTED ON THIS DRAWING AS THIS DRAWING WILL BE CONSIDERED ALL INCLUSIVE \*\*\*

ALL GRAPHICS PROVIDED ARE FOR REFERENCE ONLY. IF CERTAIN DIMENSIONS ARE CRITICAL PLEASE VERIFY THOSE DIMENSIONS WITH YOUR SALESPERSON

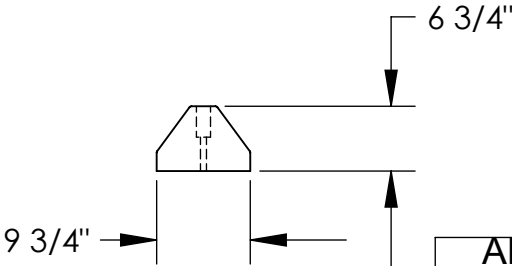
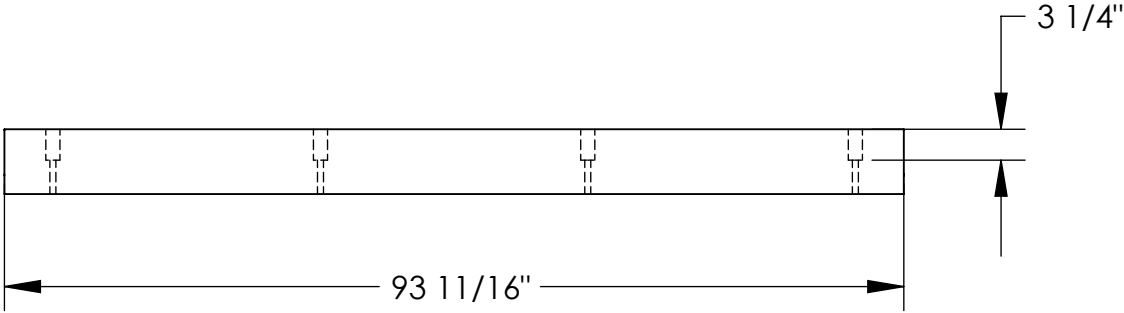
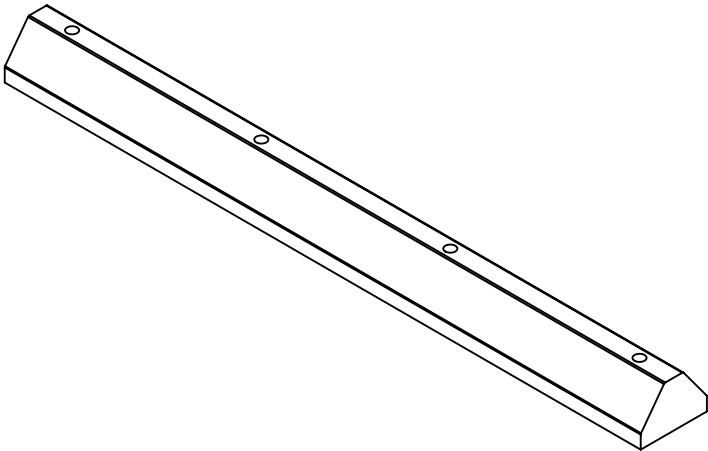
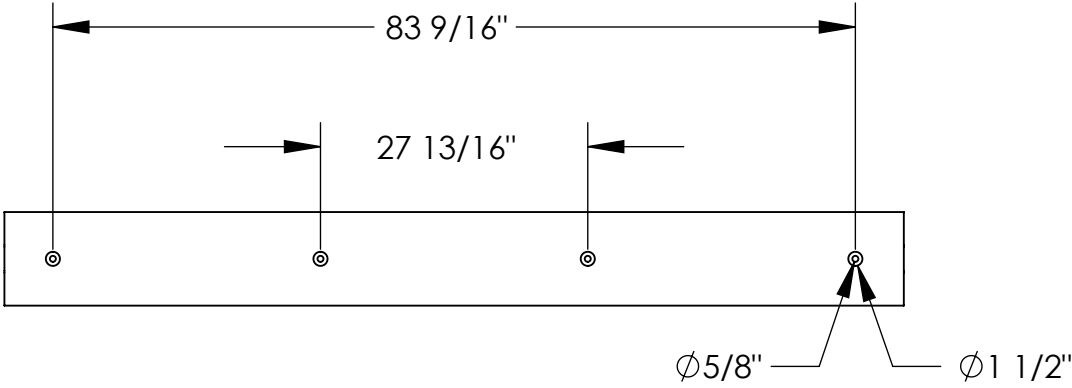

ALL SPECIAL UNITS  
ARE NON-RETURNABLE

## STANDARD FEATURES

MODEL NUMBER IS: CS-TB96-G  
OVERALL WIDTH IS: 9 3/4"  
USABLE WIDTH IS: 9 3/4"  
OVERALL LENGTH IS: 93 11/16"  
USABLE LENGTH IS: 93 11/16"  
OVERALL HEIGHT IS: 6 3/4"  
COUNTERBORE DEPTH IS: 3 3/16"

## SPECIAL FEATURES

NONE

A P P R O V A L	I, the undersigned, hereby approve this print. This includes my approval of design & dimensions	
	<input type="checkbox"/> As drawn <input type="checkbox"/> As marked	
	Signed: _____ Date: _____	
	LEAD TIME WILL START UPON RECEIPT OF SIGNED APPROVAL DRAWING	

DISTRIBUTOR'S NAME: VESTIL MANUFACTURING		P.O.# X
DRAWN BY: T. Moore	DATE: 03/17/08	W.O.# X
REFERENCE: X	QUOTE # X	SALES: X
		FILE NAME: 29-007-085