

ECONOMICAL DRUM TRANSPORTER - DCR-880-M

APPROX WEIGHT: 237.75 lbs.
DOES NOT INCLUDE WEIGHT OF POWER OR PACKAGING!!!

*** ANY ADDITIONS, DELETIONS, OR OMISSIONS MUST BE CORRECTED ON THIS DRAWING AS THIS DRAWING WILL BE CONSIDERED ALL INCLUSIVE ***

ALL GRAPHICS PROVIDED ARE FOR REFERENCE ONLY. IF CERTAIN DIMENSIONS ARE CRITICAL PLEASE VERIFY THOSE DIMENSIONS WITH YOUR SALESPERSON

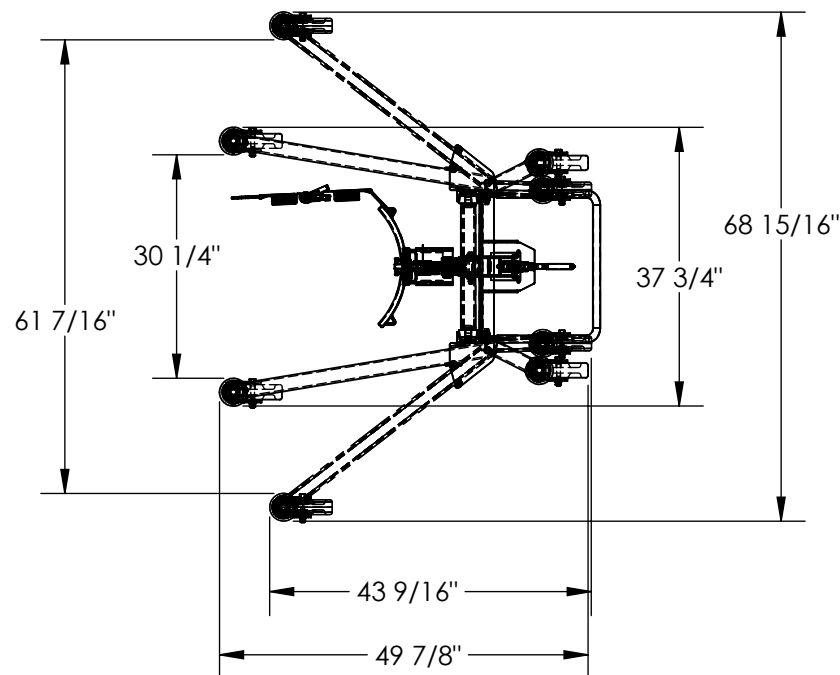

STANDARD FEATURES

MODEL NUMBER:DCR-880-M
CAPACITY: 880 LBS
FRAME HEIGHT: 41 1/2"
OVERALL RAISED HEIGHT: 54 3/16"
MAX OVERALL LENGTH: 49 7/8"
MIN OVERALL LENGTH: 43 9/16"
MAX OVERALL WIDTH: 68 15/16"
MIN OVERALL WIDTH: 37 3/4"
MAX INSIDE WIDTH: 61 7/16"
MIN INSIDE WIDTH: 30 1/4"
JAW RAISED HEIGHT: 45 3/4"
JAW LOWERED HEIGHT: 31 3/4"
HAND RATCHET OPERATION
(4) Ø8" x 2" SWIVEL CASTERS
INCLUDES SAFETY STRAP
TOUGH BAKED IN POWDER COATED YELLOW FINISH

SPECIAL FEATURES

NONE

FOR INTERNAL USE ONLY
PROJECT SIGN OFF

SALES	
ENG.	
FAB.	
POWER	

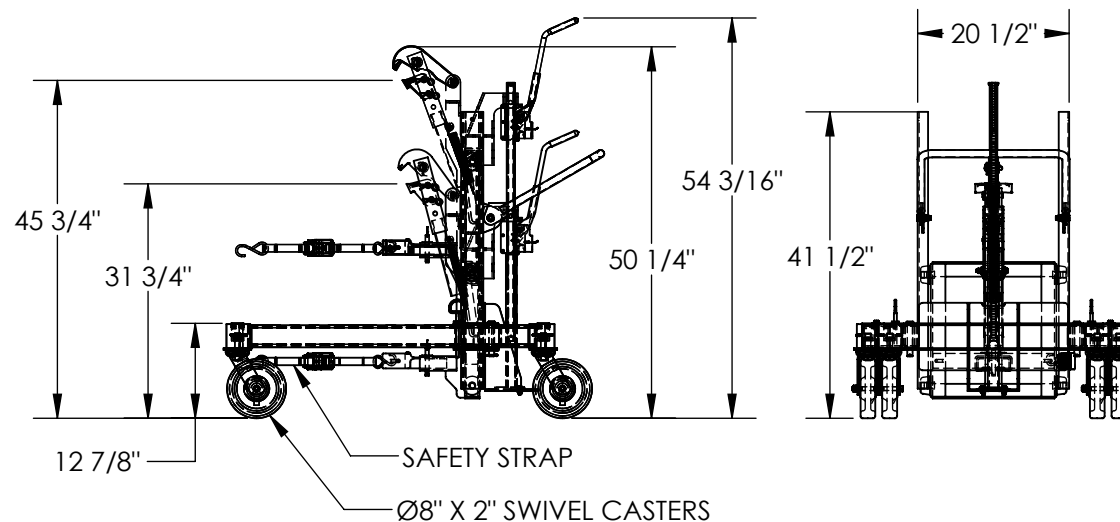

DIMENSION TOLERANCE $\pm 1/4"$

APPROVAL

I, THE UNDERSIGNED, AGREE THAT THE PRODUCT AS REPRESENTED SATISFIES DESIGN AND DIMENSION REQUIREMENTS. I ALSO ACKNOWLEDGE MY DUTY TO CONFIRM PRODUCT AND INSTALLATION COMPLIANCE WITH ALL APPLICABLE FEDERAL, STATE AND LOCAL REGULATIONS AND STANDARDS.

ANY MODIFIED UNITS ARE NON-RETURNABLE

[] As drawn [] As marked

Signed: _____ Date: _____

Printed Name: _____

LEAD TIME WILL START UPON RECEIPT OF SIGNED APPROVAL DRAWING

DISTRIBUTOR'S NAME:		P.O.#
VESTIL MANUFACTURING		X
DRAWN BY: WHR		W.O.#
DATE: 02/21/12		X
REFERENCE: X	SCALE: 1:26	SALES: X
QUOTED LEAD TIME: X	QUOTE # X	FILE NAME:
		40-007-013