

ERGO DRAIN CART - DH-PH4-2472-D

APPROX WEIGHT: 273.53 lbs.
DOES NOT INCLUDE WEIGHT OF POWER OR PACKAGING!!!

*** ANY ADDITIONS, DELETIONS, OR OMISSIONS MUST BE CORRECTED ON THIS DRAWING AS THIS DRAWING WILL BE CONSIDERED ALL INCLUSIVE ***

ALL GRAPHICS PROVIDED ARE FOR REFERENCE ONLY. IF CERTAIN DIMENSIONS ARE CRITICAL PLEASE VERIFY THOSE DIMENSIONS WITH YOUR SALESPERSON

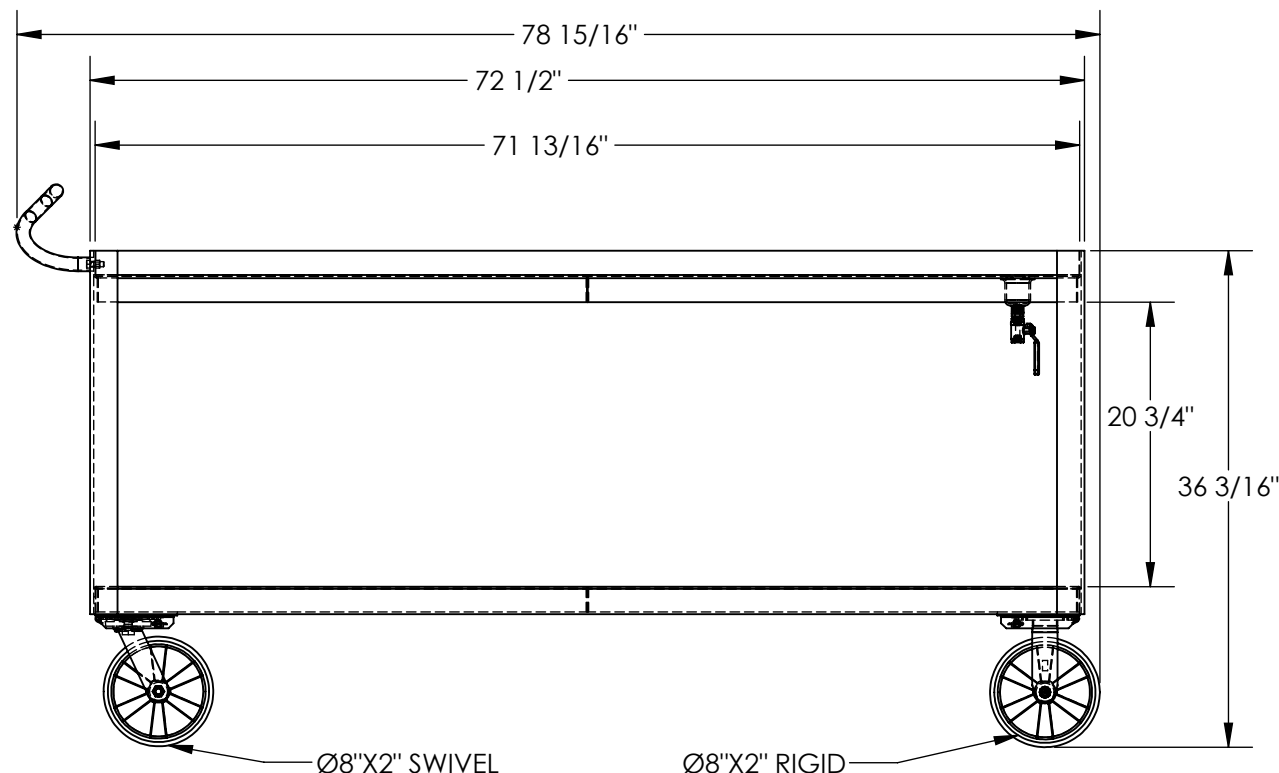
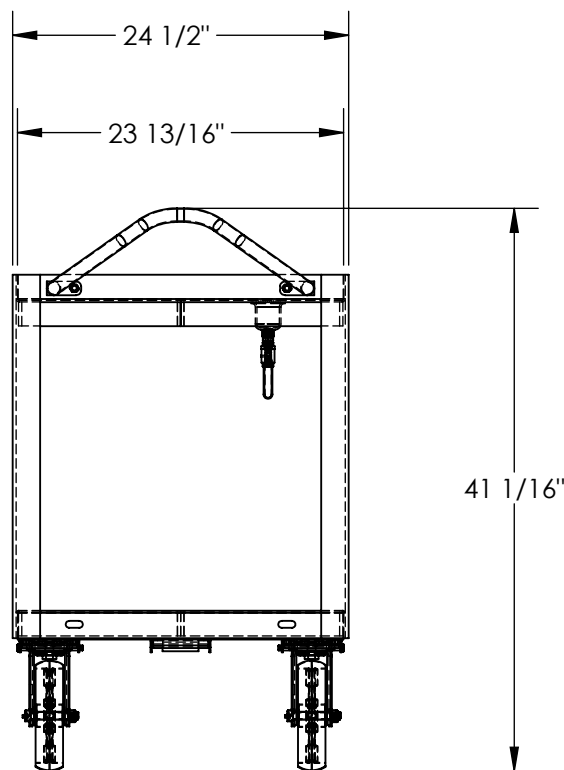

DIMENSION TOLERANCE $\pm 1/4$ "

STANDARD FEATURES

MODEL NUMBER IS DH-PH4-2472-D
MAXIMUM CART CAPACITY IS 4,000 LBS.
MAXIMUM SHELF CAPACITY IS 2,000 LBS.
NOT TO EXCEED MAXIMUM CAPACITY OF THE CART
OVERALL WIDTH IS: 24 1/2"
USABLE WIDTH IS: 23 13/16"
OVERALL LENGTH IS: 78 15/16"
USABLE LENGTH IS: 71 13/16"
OVERALL HEIGHT IS: 41 1/16"
SHELF CLEARANCE IS: 20 3/4"
2 RIGID 8"X2" GLASS FILLED NYLON CASTERS
2 SWIVEL 8"X2" GLASS FILLED NYLON CASTERS
STEEL CONSTRUCTION
TOUGH BAKED IN POWDER COATED YELLOW FINISH

SPECIAL FEATURES

NONE

**A
P
P
R
O
V
A
L**

I, THE UNDERSIGNED, AGREE THAT THE PRODUCT AS REPRESENTED SATISFIES DESIGN AND DIMENSION REQUIREMENTS. I ALSO ACKNOWLEDGE MY DUTY TO CONFIRM PRODUCT AND INSTALLATION COMPLIANCE WITH ALL APPLICABLE FEDERAL, STATE AND LOCAL REGULATIONS AND STANDARDS.
UNITS REQUIRING APPROVAL DRAWINGS OR MODIFIED ARE NON-RETURNABLE
[] As drawn [] As marked

Signed: _____ Date: _____

Printed Name: _____

LEAD TIME WILL START UPON RECEIPT OF SIGNED APPROVAL DRAWING

DISTRIBUTOR'S NAME:		P.O.#
VESTIL MANUFACTURING		X
DRAWN BY: DLS		W.O.#
DATE: 08/01/12		X
REFERENCE: X	SCALE: 1:14	SALES: X
QUOTED LEAD TIME: X	QUOTE # X	FILE NAME:
		16-007-336