

FIXED ALUMINUM GANTRY CRANE - FHA-6-10-10

APPROX WEIGHT: 494 lbs.
DOES NOT INCLUDE WEIGHT OF POWER OR PACKAGING!!!

*** ANY ADDITIONS, DELETIONS, OR OMISSIONS MUST BE CORRECTED ON THIS DRAWING AS THIS DRAWING WILL BE CONSIDERED ALL INCLUSIVE ***

ALL GRAPHICS PROVIDED ARE FOR REFERENCE ONLY. IF CERTAIN DIMENSIONS ARE CRITICAL PLEASE VERIFY THOSE DIMENSIONS WITH YOUR SALESPERSON

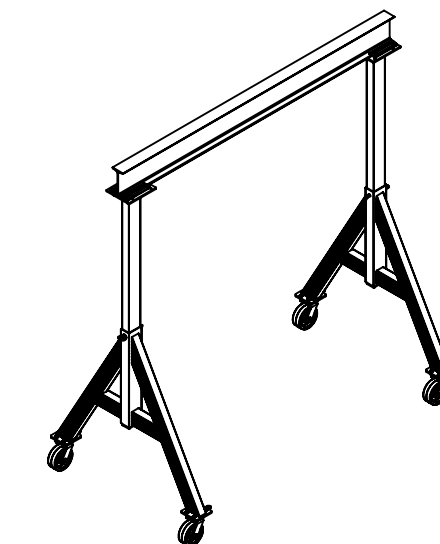
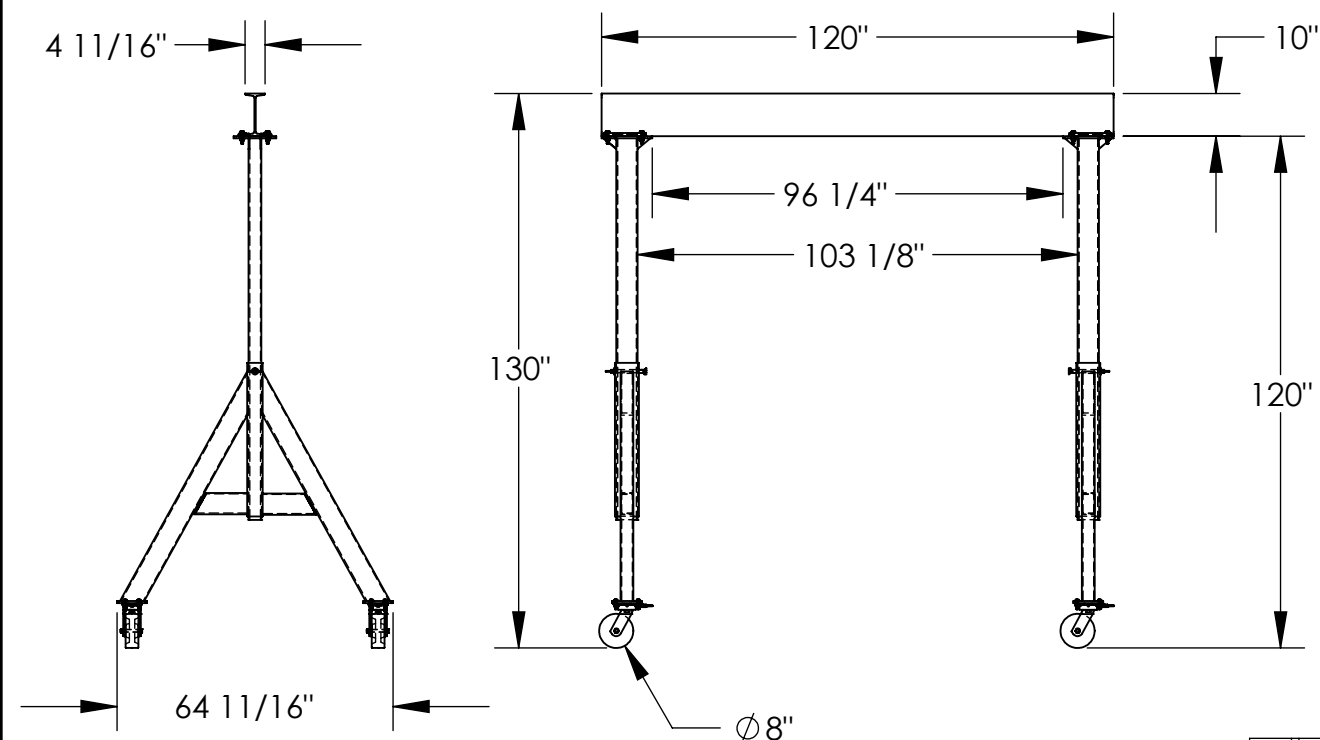

3D VIEW FOR REFERENCE ONLY

DIMENSION TOLERANCE $\pm 1/4"$

APPROVAL	I, THE UNDERSIGNED, AGREE THAT THE PRODUCT AS REPRESENTED SATISFIES DESIGN AND DIMENSION REQUIREMENTS. I ALSO ACKNOWLEDGE MY DUTY TO CONFIRM PRODUCT AND INSTALLATION COMPLIANCE WITH ALL APPLICABLE FEDERAL, STATE AND LOCAL REGULATIONS AND STANDARDS.	
	UNITS REQUIRING APPROVAL DRAWINGS OR MODIFIED ARE NON-RETURNABLE	
	[] As drawn [] As marked	
	Signed: _____ Date: _____	
Printed Name: _____		
LEAD TIME WILL START UPON RECEIPT OF SIGNED APPROVAL DRAWING		

DISTRIBUTOR'S NAME:		P.O.#
VESTIL MANUFACTURING		X
W.O.#		X
DRAWN BY: MTS	DATE: 08/18/2014	SALES: X
REFERENCE: X	SCALE: 1:45	FILE NAME:
QUOTED LEAD TIME: X	QUOTE # X	28-007-409

STANDARD FEATURES

MODEL NUMBER IS FHA-6-10-10
CAPACITY IS 6,000 LBS.
BASE WIDTH IS 64 11/16"
OVERALL HEIGHT IS 130"
I-BEAM HEIGHT IS 10"
I-BEAM FLANGE WIDTH IS 4 11/16"
OVERALL I-BEAM LENGTH IS 120"
USABLE I-BEAM LENGTH IS 96 1/4"
UNDER I-BEAM HEIGHT IS 120"
CASTERS: (4) Ø8" X 3" WIDE
PHENOLIC SWIVEL CASTERS
WITH FOUR LOCKING POSITIONS
CRANE MAY BE TAKEN APART AND BUNDLED WITH
(2) INCLUDED STRAPS FOR EASY TRANSPORT
ALUMINUM CONSTRUCTION

SPECIAL FEATURES

NONE