

# STATIONARY LEGS - FHS-STLO-RF

APPROX WEIGHT: 26.56 lbs.  
DOES NOT INCLUDE WEIGHT OF POWER OR PACKAGING!!!

\*\*\* ANY ADDITIONS, DELETIONS, OR OMISSIONS MUST BE CORRECTED ON THIS DRAWING AS THIS DRAWING WILL BE CONSIDERED ALL INCLUSIVE \*\*\*

ALL GRAPHICS PROVIDED ARE FOR REFERENCE ONLY. IF CERTAIN DIMENSIONS ARE CRITICAL PLEASE VERIFY THOSE DIMENSIONS WITH YOUR SALESPERSON

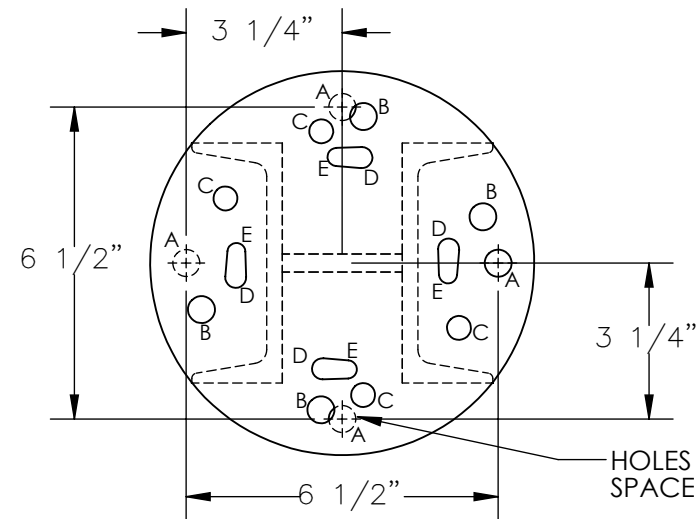

## HOLE CHART \*

- A = HOLES IN BASE ARE (4)  $\phi 9/16$  - (BASE HARDWARE NOT INCLUDED)
- B = HOLES FOR **FHS-8/AHA-6** ARE (4)  $\phi 9/16$  --- 28-154-049
- C = HOLES FOR **FHS-6** ARE (4)  $\phi 1/2$  ----- 28-154-050 MOUNTING HARWARE KIT NEEDED
- D = HOLES FOR **AHA-2/-4** ARE (4)  $\phi 7/16$  ----- 28-154-051 FOR GANTRY MODEL LISTED
- E = HOLES FOR **FHS-2/-4** ARE (4)  $\phi 3/8$  ----- 28-154-052

HOLES AND HARDWARE FOR FHSN GANTRY CRANES ARE THE SAME AS THE FHS MODEL OF MATCHING SIZE

\* = THE FHS-STLO-RF STATIONARY LEG HAS HOLES FOR ALL MODELS OF GANTRY CRANES, USE THE HOLES LISTED IN THE CHART FOR THE MODEL OF CRANE BEING USED.

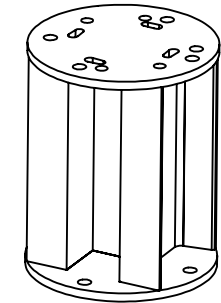

3-D VIEW FOR REFERENCE

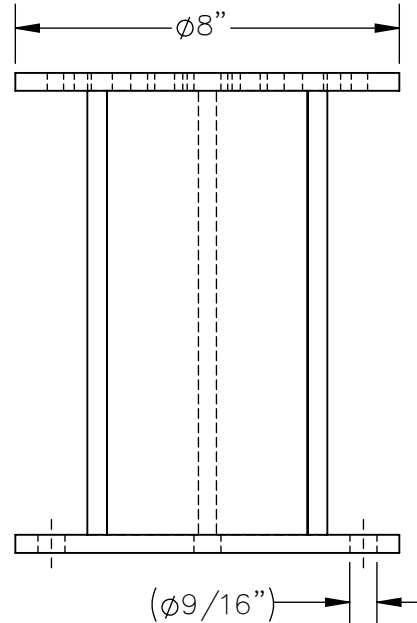
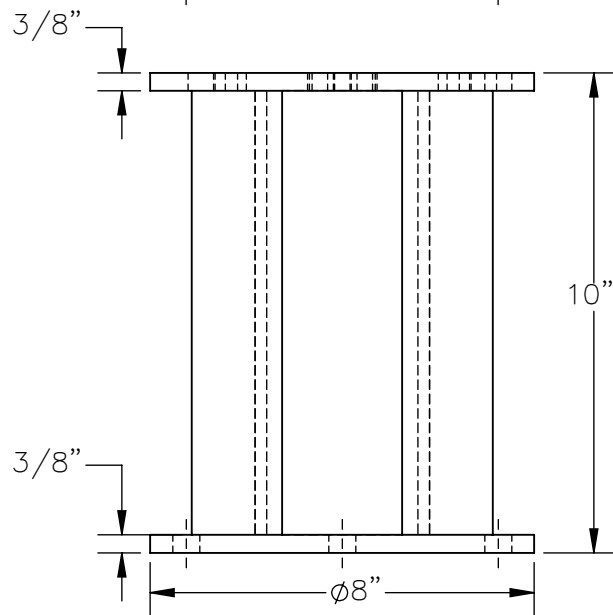

HOLES IN BASE ARE  $9/16$  AND SPACED  $6\ 1/2$ " APART AS SHOWN

(4) WELDMENTS AND (4) MOUNTING HARDWARE KITS ARE REQUIRED FOR THE BOLT DOWN OPTION FOR A GANTRY CRANE.

DIMENSION TOLERANCE  $\pm 1/4$ "

### STANDARD FEATURES

- MODEL NUMBER IS FHS-STLO-RF
- BOLT TO BOTTOM OF AHS GANTRY CRANES FOR USE WITHOUT CASTERS
- OVERALL WIDTH IS 8"
- OVERALL LENGTH IS 8"
- OVERALL HEIGHT IS 10"
- STATIONARY LEGS ARE WELDED STEEL CONSTRUCTION

### SPECIAL FEATURES

NONE

<b>APPROVAL</b>	I, THE UNDERSIGNED, AGREE THAT THE PRODUCT AS REPRESENTED SATISFIES DESIGN AND DIMENSION REQUIREMENTS. I ALSO ACKNOWLEDGE MY DUTY TO CONFIRM PRODUCT AND INSTALLATION COMPLIANCE WITH ALL APPLICABLE FEDERAL, STATE AND LOCAL REGULATIONS AND STANDARDS.	
	<b>ANY MODIFIED UNITS ARE NON-RETURNABLE</b>	
	[ ] As drawn [ ] As marked	
	Signed: _____ Date: _____	
Printed Name: _____		
<b>LEAD TIME WILL START UPON RECEIPT OF SIGNED APPROVAL DRAWING</b>		

FOR INTERNAL USE ONLY PROJECT SIGN OFF	
SALES	
ENG.	
FAB.	
POWER	

DISTRIBUTOR'S NAME:		P.O.#
<b>VESTIL MANUFACTURING</b>		X
		W.O.#
DRAWN BY: MTS	DATE: 03/31/2017	SALES: X
REFERENCE: X	SCALE: 1:4	FILE NAME:
QUOTED LEAD TIME: X	QUOTE # X	28-007-415-005