

APPROX WEIGHT: 598.22 lbs.
DOES NOT INCLUDE WEIGHT OF POWER OR PACKAGING!!!

FIXED STEEL GANTRY CRANE - KNOCKDOWN - FHSN-50

*** ANY ADDITIONS, DELETIONS, OR OMISSIONS MUST BE CORRECTED ON THIS DRAWING AS THIS DRAWING WILL BE CONSIDERED ALL INCLUSIVE ***
ALL GRAPHICS PROVIDED ARE FOR REFERENCE ONLY. IF CERTAIN DIMENSIONS ARE CRITICAL PLEASE VERIFY THOSE DIMENSIONS WITH YOUR SALESPERSON

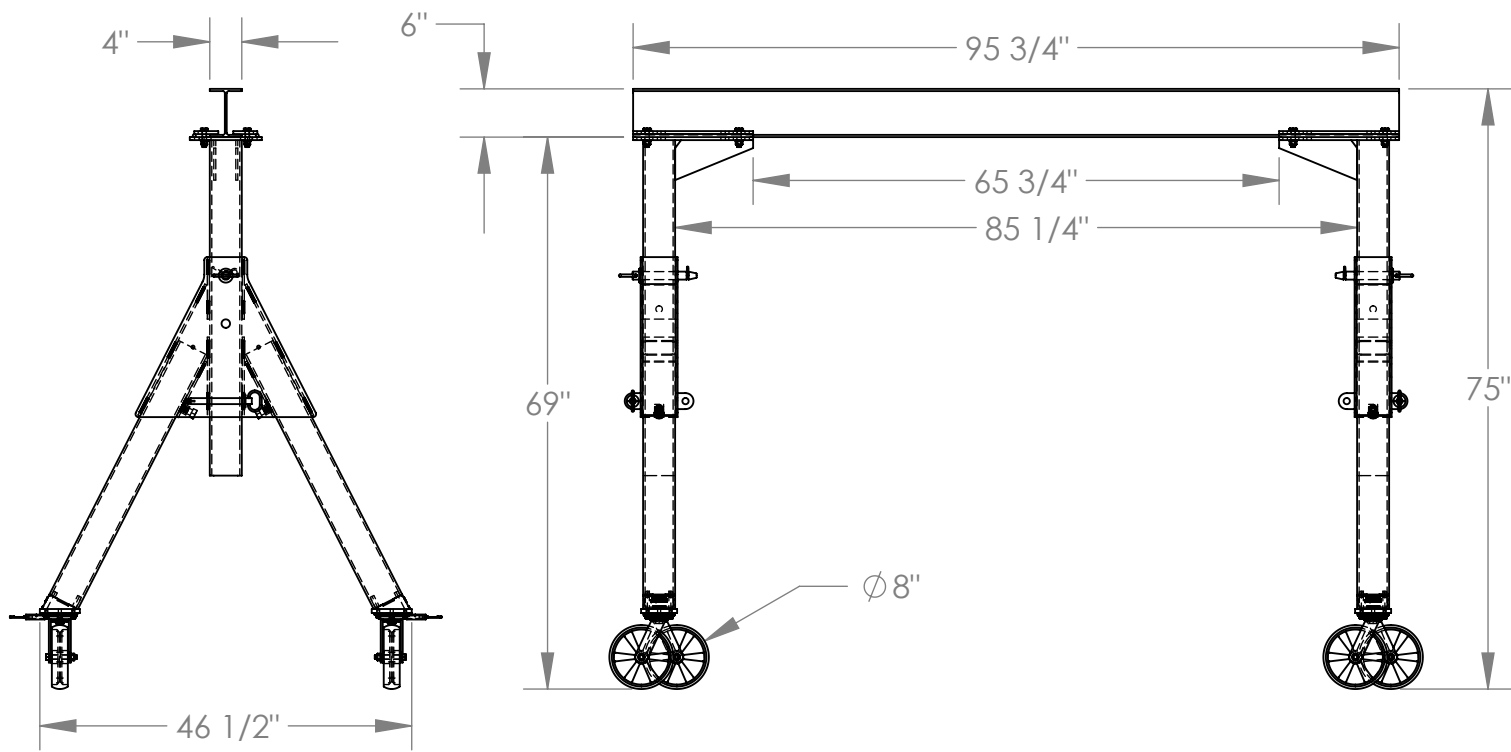

STANDARD FEATURES

MODEL NUMBER IS FHSN-50
CAPACITY IS 500 LBS.
BASE WIDTH IS 46 1/2"
OVERALL HEIGHT IS 75"
I-BEAM HEIGHT IS 6"
I-BEAM FLANGE WIDTH IS 4"
OVERALL I-BEAM LENGTH IS 95 3/4"
USABLE I-BEAM LENGTH IS 65 3/4"
UNDER I-BEAM HEIGHT IS 69"
CASTERS: (4) Ø8" X 2" WIDE GLASS FILLED
NYLON SWIVEL CASTERS WITH FOUR
LOCKING POSITIONS

SPECIAL FEATURES

NONE

DIMENSION TOLERANCE ± 1/4"

APPROVAL	I, THE UNDERSIGNED, AGREE THAT THE PRODUCT AS REPRESENTED SATISFIES DESIGN AND DIMENSION REQUIREMENTS. I ALSO ACKNOWLEDGE MY DUTY TO CONFIRM PRODUCT AND INSTALLATION COMPLIANCE WITH ALL APPLICABLE FEDERAL, STATE AND LOCAL REGULATIONS AND STANDARDS.	
	ANY MODIFIED UNITS ARE NON-RETURNABLE	
	[] As drawn [] As marked	
	Signed: _____ Date: _____	
Printed Name: _____		
LEAD TIME WILL START UPON RECEIPT OF SIGNED APPROVAL DRAWING		

FOR INTERNAL USE ONLY PROJECT SIGN OFF	
SALES	
ENG.	
FAB.	
POWER	

DISTRIBUTOR'S NAME:		P.O.#
VESTIL MANUFACTURING		X
DRAWN BY: MTS		W.O.#
DATE: 06/25/15		X
REFERENCE: X	SCALE: 1:24	SALES: X
QUOTED LEAD TIME: X	QUOTE # X	FILE NAME:
		28-007-376