

APPROX WEIGHT: 86.32 lbs.  
DOES NOT INCLUDE WEIGHT OF POWER OR PACKAGING!!!

FLUSH TOP DOLLY - FTD-1616-8

\*\*\* ANY ADDITIONS, DELETIONS, OR OMISSIONS MUST BE CORRECTED ON THIS DRAWING AS THIS DRAWING WILL BE CONSIDERED ALL INCLUSIVE \*\*\*  
ALL GRAPHICS PROVIDED ARE FOR REFERENCE ONLY. IF CERTAIN DIMENSIONS ARE CRITICAL PLEASE VERIFY THOSE DIMENSIONS WITH YOUR SALESPERSON

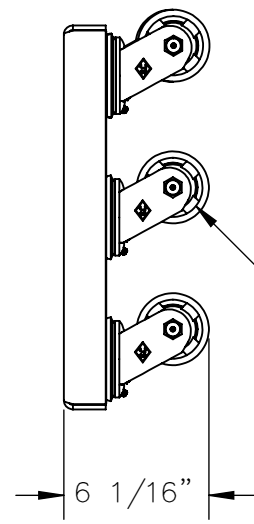
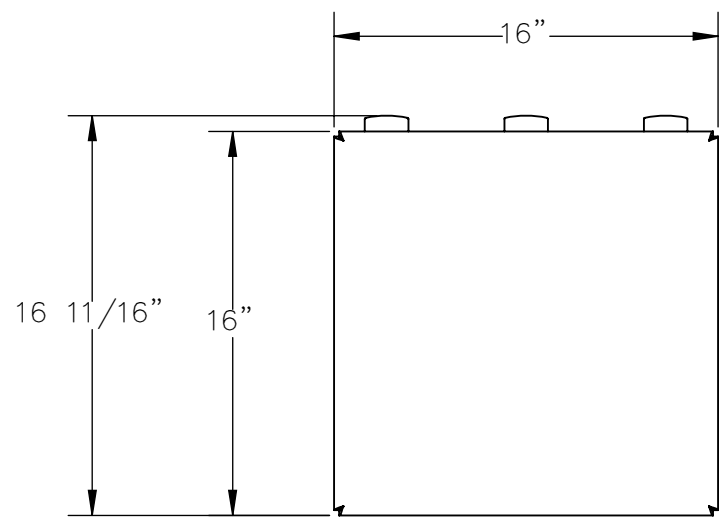

GLASS FILLED NYLON  
SWIVEL STEM CASTER

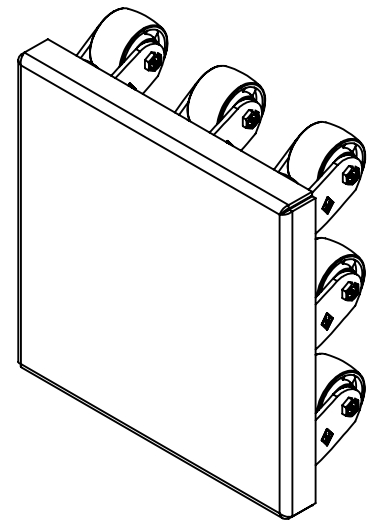

STANDARD FEATURES

- MODEL NUMBER IS FTD-1616-8
- OVERALL WIDTH IS 16"
- OVERALL LENGTH IS 16 11/16"
- PLATFORM LENGTH IS 16"
- OVERALL HEIGHT IS 6 1/16"
- MAX CAPACITY IS 8,000 LBS
- QTY 9 - 3 X 2 GLASS FILLED NYLON SWIVEL STEM CASTER
- DURABLE BAKED IN POWDER COAT BLUE FINISH

SPECIAL FEATURES

NONE

DIMENSION TOLERANCE ± 1/4"

APPROVAL	I, THE UNDERSIGNED, AGREE THAT THE PRODUCT AS REPRESENTED SATISFIES DESIGN AND DIMENSION REQUIREMENTS. I ALSO ACKNOWLEDGE MY DUTY TO CONFIRM PRODUCT AND INSTALLATION COMPLIANCE WITH ALL APPLICABLE FEDERAL, STATE AND LOCAL REGULATIONS AND STANDARDS.	
	<b>UNITS REQUIRING APPROVAL DRAWINGS OR MODIFIED ARE NON-RETURNABLE</b>	
	[ ] As drawn      [ ] As marked	
	Signed: _____ Date: _____	
Printed Name: _____		
LEAD TIME WILL START UPON RECEIPT OF SIGNED APPROVAL DRAWING		

DISTRIBUTOR'S NAME:		P.O.#
VESTIL MANUFACTURING		X
		W.O.#
		X
DRAWN BY: TAL	DATE: 5/12/2024	SALES: X
REFERENCE: X	SCALE: 1:8	FILE NAME:
QUOTED LEAD TIME: X	QUOTE # X	16-007-553