

HYDRAULIC DRUM STACKER - HDC-450-60

APPROX WEIGHT: 540.58 lbs.
DOES NOT INCLUDE WEIGHT OF POWER OR PACKAGING!!!

ANY ADDITIONS, DELETIONS, OR OMISSIONS MUST BE CORRECTED ON THIS DRAWING AS THIS DRAWING WILL BE CONSIDERED ALL INCLUSIVE

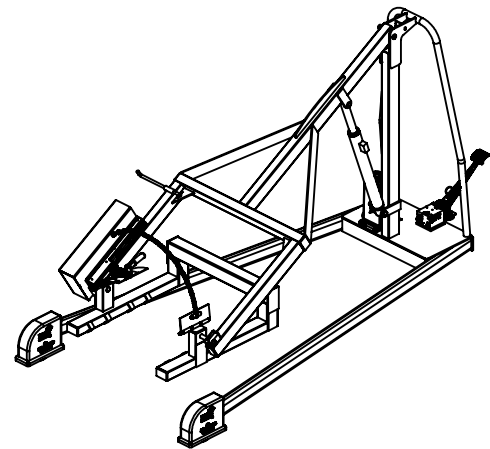
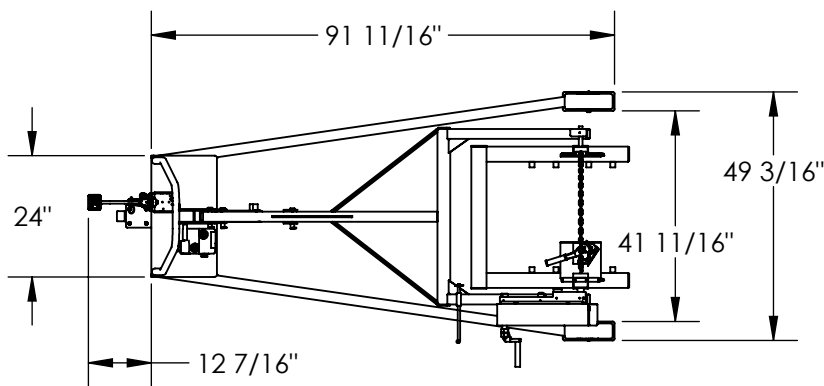

SHOWN IN LOWERED POSITION

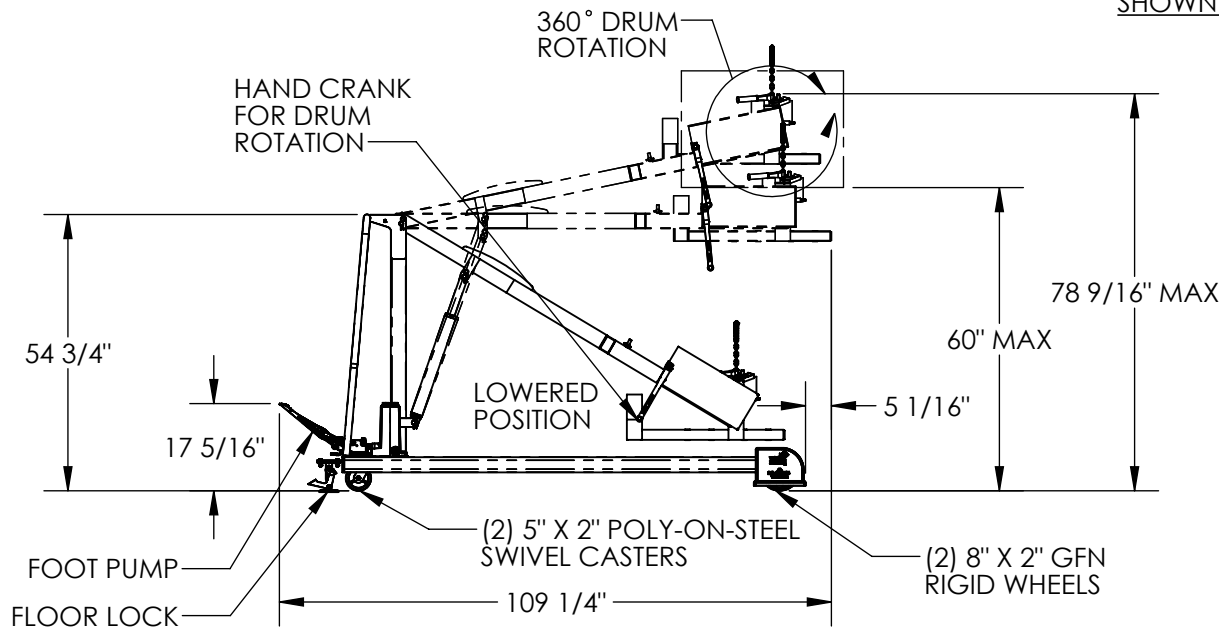

ALL GRAPHICS PROVIDED ARE FOR REFERENCE ONLY. IF CERTAIN DIMENSIONS ARE CRITICAL PLEASE VERIFY THOSE DIMENSIONS WITH YOUR SALESPERSON

STANDARD FEATURES

MODEL NUMBER IS HDC-450-60
CAPACITY IS 800 LBS
OVERALL WIDTH IS 49 3/16"
OVERALL LENGTH IS 109 1/4"
OVERALL HEIGHT IS 78 9/16"
OUT RIGGER INSIDE DIMENSION IS 41 11/16"
PUSH HANDLE HEIGHT IS 54 3/4"
DRUM RAISED HEIGHT IS 60"
(2) 5" X 2" REAR SWIVEL
POLY-ON-STEEL CASTERS
(2) 8" X 2" FRONT RIGID
GFN WHEELS
HAND CRANK DRUM ROTATION (360°)
FOOT PUMP
FLOOR LOCK
DURABLE LIQUID PAINT BLUE FINISH

SPECIAL FEATURES

NONE

DIMENSION TOLERANCE $\pm 1/4"$

APPROVAL

I, THE UNDERSIGNED, AGREE THAT THE PRODUCT AS REPRESENTED SATISFIES DESIGN AND DIMENSION REQUIREMENTS. I ALSO ACKNOWLEDGE MY DUTY TO CONFIRM PRODUCT AND INSTALLATION COMPLIANCE WITH ALL APPLICABLE FEDERAL, STATE AND LOCAL REGULATIONS AND STANDARDS.
UNITS REQUIRING APPROVAL DRAWINGS OR MODIFIED ARE NON-RETURNABLE

[] As drawn [] As marked

Signed: _____ Date: _____

Printed Name: _____

LEAD TIME WILL START UPON RECEIPT OF SIGNED APPROVAL DRAWING

DISTRIBUTOR'S NAME:

VESTIL MANUFACTURING

DRAWN BY: DEY

DATE: 12/08/11

REFERENCE: X

SCALE: 1:38

QUOTED LEAD TIME: X

QUOTE # X

P.O.# X

W.O.# X

SALES: X

FILE NAME:

09-007-033