

# LIFT-AND-DUMP HYDRAULIC DRUM DUMPERS- HLD-116-10-S

APPROX WEIGHT: 1212.02 lbs.  
DOES NOT INCLUDE WEIGHT OF POWER OR PACKAGING!!!

\*\*\* ANY ADDITIONS, DELETIONS, OR OMISSIONS MUST BE CORRECTED ON THIS DRAWING AS THIS DRAWING WILL BE CONSIDERED ALL INCLUSIVE \*\*\*

ALL GRAPHICS PROVIDED ARE FOR REFERENCE ONLY. IF CERTAIN DIMENSIONS ARE CRITICAL PLEASE VERIFY THOSE DIMENSIONS WITH YOUR SALESPERSON

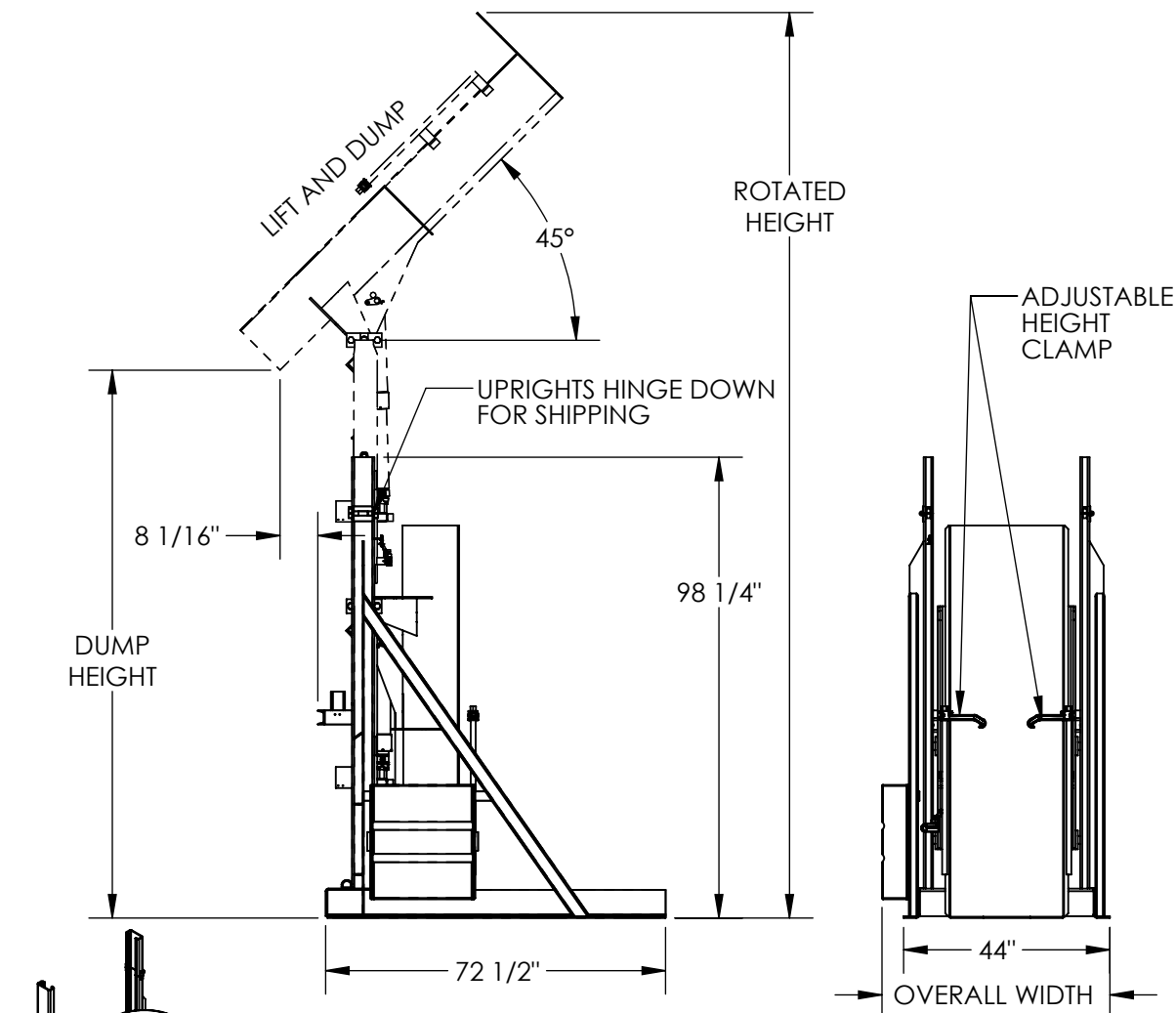

## PLEASE CIRCLE SPECIFICATIONS:

POWER	AC	* DC	* AIR/OIL
MOTOR VOLTAGE	115	208	230 460
DEDICATED CIRCUIT REQUIRED			
MOTOR PHASE	SINGLE	THREE	
CONTROL	HAND	* FOOT	
~ ALL BATTERY CHARGERS ARE 115V AC ~			
BATTERY CHRG.	REMOTE	ON-BOARD	
CHRG. INDICATOR	YES	NO	

\* AVAILABLE AT ADDITIONAL COST

## STANDARD FEATURES

MODEL NUMBER IS HLD-116-10-S  
LIFT AND DUMP DESIGN  
INDEPENDENT LIFT AND DUMP OPERATION  
MAX. DUMP HEIGHT IS 116"  
MIN. DUMP HEIGHT IS 60"  
OVERALL WIDTH IS 51"  
OVERALL LENGTH IS 72 1/2"  
LEVEL HEIGHT IS 98 1/4"  
ROTATED HEIGHT IS 194"  
DUMP ANGLE IS 45°  
UNIT IS STATIONARY  
MAX CAPACITY IS 1,000 LBS.  
DURABLE LIQUID PAINT BLUE FINISH FRAME  
TOUGH BAKED IN POWDER COATED  
YELLOW FINISH CHUTE  
3000 PSI HYD. COMPONENT RATING  
WARNING:  
CHECK LOCAL AND STATE CODES!

## SPECIAL FEATURES

NONE

DIMENSION TOLERANCE  $\pm 1/4"$

APPROVAL

I, THE UNDERSIGNED, AGREE THAT THE PRODUCT AS REPRESENTED SATISFIES DESIGN AND DIMENSION REQUIREMENTS. I ALSO ACKNOWLEDGE MY DUTY TO CONFIRM PRODUCT AND INSTALLATION COMPLIANCE WITH ALL APPLICABLE FEDERAL, STATE AND LOCAL REGULATIONS AND STANDARDS.  
**UNITS REQUIRING APPROVAL DRAWINGS OR MODIFIED ARE NON-RETURNABLE**

[ ] As drawn [ ] As marked

Signed: \_\_\_\_\_ Date: \_\_\_\_\_

Printed Name: \_\_\_\_\_

LEAD TIME WILL START UPON RECEIPT OF SIGNED APPROVAL DRAWING

DISTRIBUTOR'S NAME:

VESTIL MANUFACTURING

DRAWN BY: CA

DATE: 09/02/2011

REFERENCE: X

SCALE: 1:40

QUOTED LEAD TIME: X

QUOTE # X

P.O.# X

W.O.# X

SALES: X

FILE NAME:

09-007-098