

APPROX WEIGHT: 430.57 lbs.
DOES NOT INCLUDE WEIGHT OF POWER OR PACKAGING!!!

HORIZONTAL RETENTION BASIN - HSRB-4-BL

*** ANY ADDITIONS, DELETIONS, OR OMISSIONS MUST BE CORRECTED ON THIS DRAWING AS THIS DRAWING WILL BE CONSIDERED ALL INCLUSIVE ***
ALL GRAPHICS PROVIDED ARE FOR REFERENCE ONLY. IF CERTAIN DIMENSIONS ARE CRITICAL PLEASE VERIFY THOSE DIMENSIONS WITH YOUR SALESPERSON

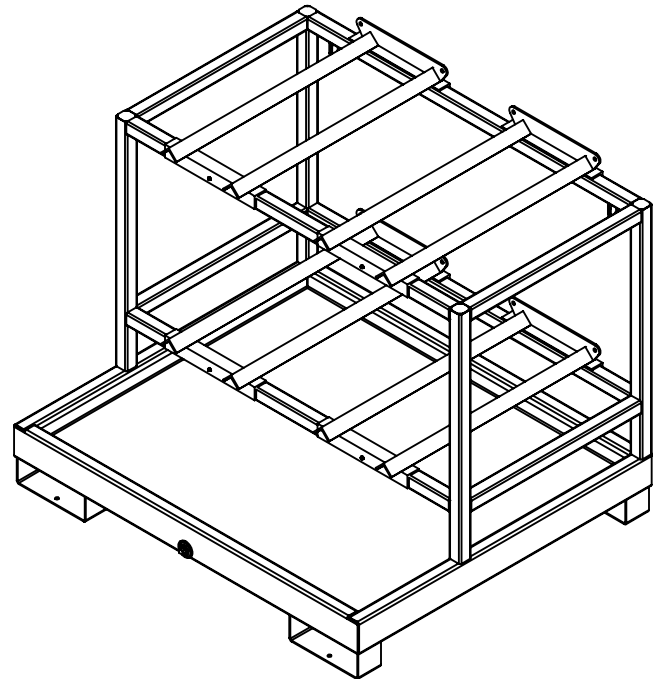
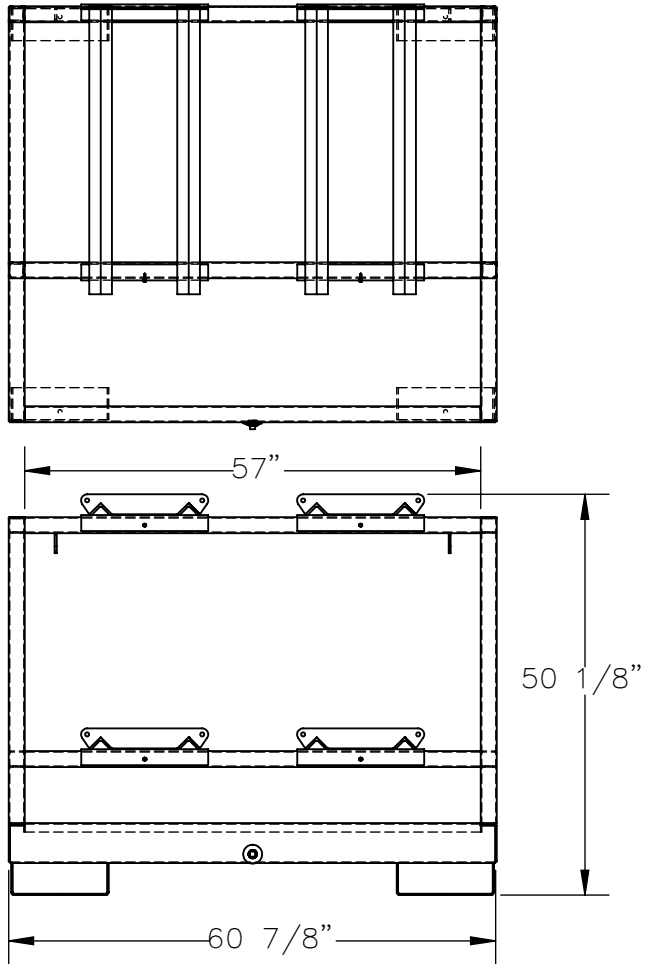

DIMENSION TOLERANCE ± 1/4"

STANDARD FEATURES

- MODEL NUMBER IS HSRB-4-BL
- OVERALL WIDTH IS 60 7/8"
- USABLE WIDTH IS 57"
- OVERALL LENGTH IS 52 7/8"
- USABLE LENGTH IS 48"
- OVERALL HEIGHT IS 50 1/8"
- USABLE HEIGHT IS 27 1/4"
- MAX CAPACITY IS 2400 LBS
- CAPACITY PER SHELF IS 1200 LBS
- FRAME IS DUARBLE BAKED IN POWDER COAT BLUE FINISH
- DRUM CRADLE IS DUARBLE BAKED IN POWDER COAT YELLOW FINISH

SPECIAL FEATURES

NONE

A
P
P
R
O
V
A
L

I, THE UNDERSIGNED, AGREE THAT THE PRODUCT AS REPRESENTED SATISFIES DESIGN AND DIMENSION REQUIREMENTS. I ALSO ACKNOWLEDGE MY DUTY TO CONFIRM PRODUCT AND INSTALLATION COMPLIANCE WITH ALL APPLICABLE FEDERAL, STATE AND LOCAL REGULATIONS AND STANDARDS.
UNITS REQUIRING APPROVAL DRAWINGS OR MODIFIED ARE NON-RETURNABLE
[] As drawn [] As marked

Signed: _____ Date: _____

Printed Name: _____

LEAD TIME WILL START UPON RECEIPT OF SIGNED APPROVAL DRAWING

DISTRIBUTOR'S NAME:		P.O.#	X
VESTIL MANUFACTURING		W.O.#	X
DRAWN BY:	E. GRONCZEWSKI	DATE:	5/15/2025
REFERENCE:	X	SCALE:	1:24
QUOTED LEAD TIME:	X	QUOTE #	X
		FILE NAME:	40-007-133