

# SPILL CONTAINER - ISCS-1

APPROX WEIGHT: 1018.24 lbs.  
DOES NOT INCLUDE WEIGHT OF POWER OR PACKAGING!!!

\*\*\* ANY ADDITIONS, DELETIONS, OR OMISSIONS MUST BE CORRECTED ON THIS DRAWING AS THIS DRAWING WILL BE CONSIDERED ALL INCLUSIVE \*\*\*

ALL GRAPHICS PROVIDED ARE FOR REFERENCE ONLY. IF CERTAIN DIMENSIONS ARE CRITICAL PLEASE VERIFY THOSE DIMENSIONS WITH YOUR SALESPERSON

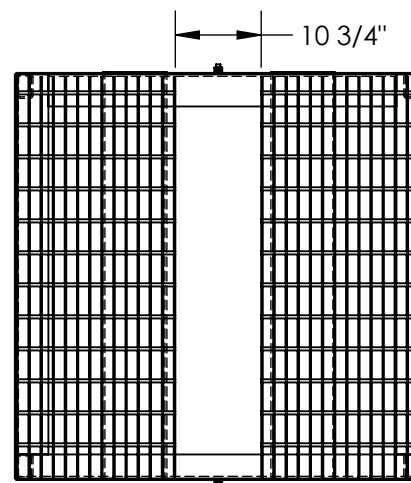
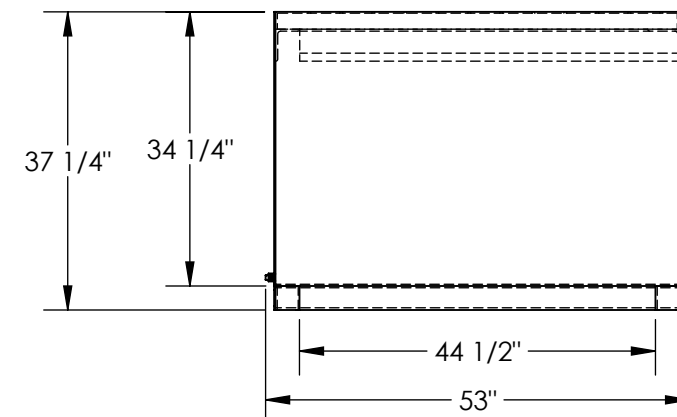
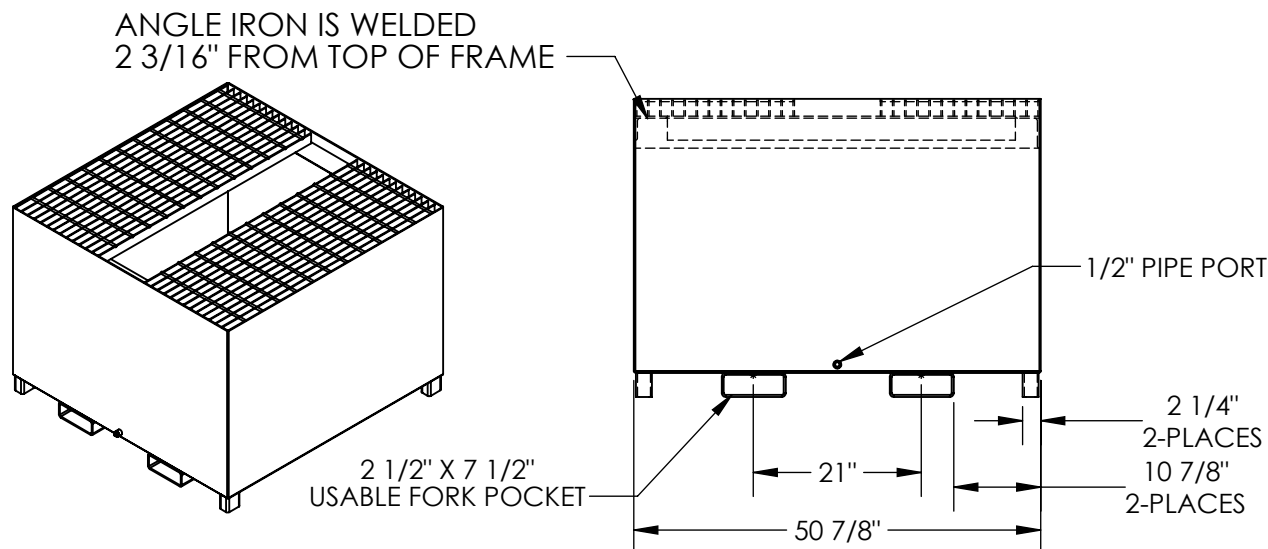

DIMENSION TOLERANCE  $\pm 1/4"$

## STANDARD FEATURES

MODEL NUMBER IS ISCS-1  
OVERALL WIDTH IS 50 7/8"  
OVERALL LENGTH IS 53"  
OVERALL HEIGHT IS 37 5/16"  
FORK POCKET CENTER TO CENTER IS 21"  
USABLE FORK POCKET SIZE IS 2 1/2" X 7 1/2"  
GRATE SPACING IS 10 3/4"  
MAX WEIGHT CAPACITY IS 2,500 LBS  
MAX FLUID CAPACITY IS 400 GALLONS  
WEIGHT WHEN FULL CAPACITY IS 4,362 LBS  
WEIGHT WHEN EMPTY IS 1,018 LBS  
GRATING IS REMOVABLE  
DURABLE LIQUID PAINT YELLOW FINISH

## SPECIAL FEATURES

NONE

APPROVAL

I, THE UNDERSIGNED, AGREE THAT THE PRODUCT AS REPRESENTED SATISFIES DESIGN AND DIMENSION REQUIREMENTS. I ALSO ACKNOWLEDGE MY DUTY TO CONFIRM PRODUCT AND INSTALLATION COMPLIANCE WITH ALL APPLICABLE FEDERAL, STATE AND LOCAL REGULATIONS AND STANDARDS.

**ANY MODIFIED UNITS ARE NON-RETURNABLE**

☐ As drawn ☐ As marked

Signed: \_\_\_\_\_ Date: \_\_\_\_\_

Printed Name: \_\_\_\_\_

LEAD TIME WILL START UPON RECEIPT OF SIGNED APPROVAL DRAWING

FOR INTERNAL USE ONLY  
PROJECT SIGN OFF

SALES	
ENG.	
FAB.	
POWER	

DISTRIBUTOR'S NAME:

VESTIL MANUFACTURING

DRAWN BY: STL

DATE: 12/12/2016

REFERENCE: X

SCALE: 1:48

QUOTED LEAD TIME: X

QUOTE #  
X

P.O.# X

W.O.# X

SALES: X

FILE NAME:

41-007-035