

# MEDIUM DUTY CANTILEVER RACKING - MU-C-10-24

APPROX WEIGHT: 192.32 lbs.  
 DOES NOT INCLUDE WEIGHT OF POWER OR PACKAGING!!!

\*\*\* ANY ADDITIONS, DELETIONS, OR OMISSIONS MUST BE CORRECTED ON THIS DRAWING AS THIS DRAWING WILL BE CONSIDERED ALL INCLUSIVE \*\*\*

ALL GRAPHICS PROVIDED ARE FOR REFERENCE ONLY. IF CERTAIN DIMENSIONS ARE CRITICAL PLEASE VERIFY THOSE DIMENSIONS WITH YOUR SALESPERSON

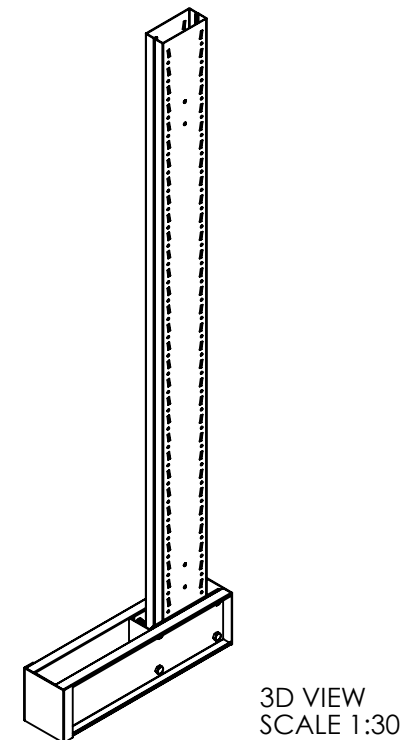
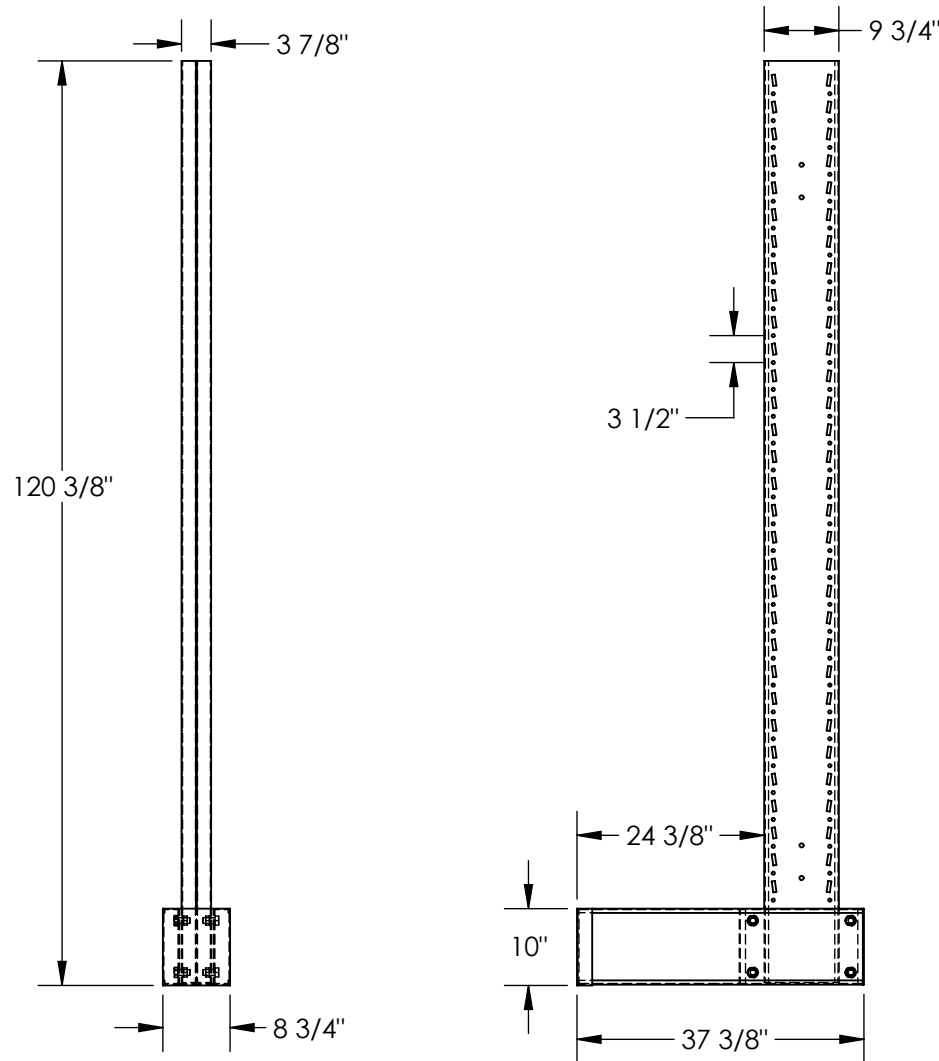

3D VIEW  
 SCALE 1:30

\*\*NOTE: MU-C-10-24  
 SOLD EACH, NOT IN PAIRS\*\*

DIMENSION TOLERANCE  $\pm 1/4$ "

## STANDARD FEATURES

- MODEL NUMBER IS MU-C-10-24
- OVERALL WIDTH IS 8 3/4"
- OVERALL LENGTH IS 37 3/8"
- OVERALL HEIGHT IS 120 3/8"
- UNIFORM CAPACITY IS 5,000 LBS. (PER UPRIGHT)
- ARMS ARE ADJUSTABLE UP AND DOWN
- ALONG FULL LENGTH OF THE UPRIGHT
- 3 1/2" BETWEEN ARM POSITIONING SLOTS
- USES 24" LONG ARMS (AVAILABLE SEPERATELY)

## SPECIAL FEATURES

NONE

<b>APPROVAL</b>	I, THE UNDERSIGNED, AGREE THAT THE PRODUCT AS REPRESENTED SATISFIES DESIGN AND DIMENSION REQUIREMENTS. I ALSO ACKNOWLEDGE MY DUTY TO CONFIRM PRODUCT AND INSTALLATION COMPLIANCE WITH ALL APPLICABLE FEDERAL, STATE AND LOCAL REGULATIONS AND STANDARDS.	
	<b>UNITS REQUIRING APPROVAL DRAWINGS OR MODIFIED ARE NON-RETURNABLE</b>	
	[ ] As drawn [ ] As marked	
	Signed: _____	Date: _____
Printed Name: _____		
<b>LEAD TIME WILL START UPON RECEIPT OF SIGNED APPROVAL DRAWING</b>		

DISTRIBUTOR'S NAME:		P.O.#
<b>VESTIL MANUFACTURING</b>		X
		W.O.#
DRAWN BY: TJM	DATE: 09/14/12	X
REFERENCE: X	SCALE: 1:25	FILE NAME:
QUOTED LEAD TIME: X	QUOTE # X	31-007-184