

# SERVICE CARTS - SCS3-2848

APPROX WEIGHT: 147.23 lbs.  
DOES NOT INCLUDE WEIGHT OF POWER OR PACKAGING!!!

\*\*\* ANY ADDITIONS, DELETIONS, OR OMISSIONS MUST BE CORRECTED ON THIS DRAWING AS THIS DRAWING WILL BE CONSIDERED ALL INCLUSIVE \*\*\*

ALL GRAPHICS PROVIDED ARE FOR REFERENCE ONLY. IF CERTAIN DIMENSIONS ARE CRITICAL PLEASE VERIFY THOSE DIMENSIONS WITH YOUR SALESPERSON

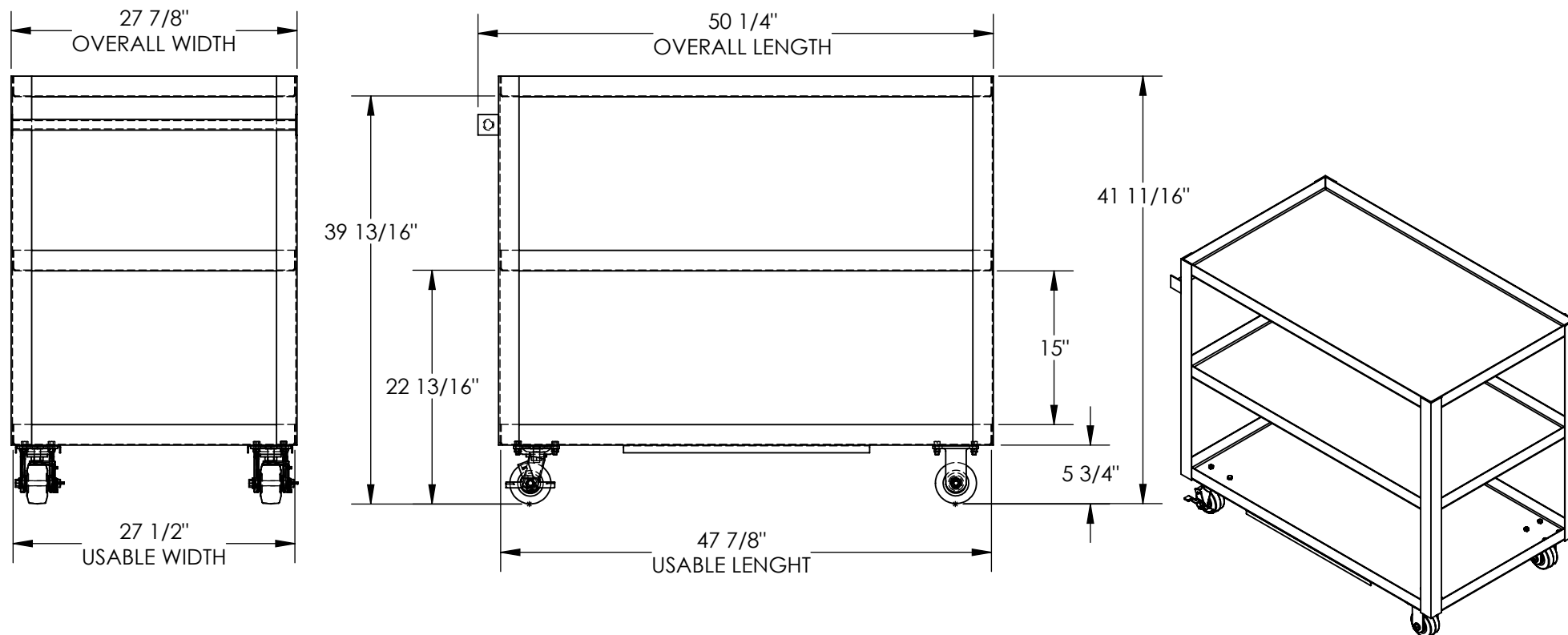

## STANDARD FEATURES

MODEL NUMBER IS SCS3-2848  
OVERALL WIDTH IS 27 7/8"  
USABLE WIDTH IS 27 1/2"  
OVERALL LENGTH IS 50 1/4"  
USABLE LENGTH IS 47 7/8"  
OVERALL HEIGHT IS 41 11/16"  
MAX CAPACITY IS 1,000 lbs. (550 LBS. PER SHELF)  
STEEL FRAME CONSTRUCTION  
SHELF CLEARANCE 15"  
USABLE SHELF HEIGHT IS 22 13/16", 39 13/16"  
TOUGH BAKED IN POWDER COATED BLUE FINISH  
Ø 4" X 2" MOLD ON RUBBER  
2 - SWIVEL CASTERS WITH BRAKE  
2 - RIGID CASTERS

## SPECIAL FEATURES

NONE

DIMENSION TOLERANCE ± 1/4"

**A  
P  
P  
R  
O  
V  
A  
L**

I, THE UNDERSIGNED, AGREE THAT THE PRODUCT AS REPRESENTED SATISFIES DESIGN AND DIMENSION REQUIREMENTS. I ALSO ACKNOWLEDGE MY DUTY TO CONFIRM PRODUCT AND INSTALLATION COMPLIANCE WITH ALL APPLICABLE FEDERAL, STATE AND LOCAL REGULATIONS AND STANDARDS.  
**UNITS REQUIRING APPROVAL DRAWINGS OR MODIFIED ARE NON-RETURNABLE**

[ ] As drawn [ ] As marked

Signed: \_\_\_\_\_ Date: \_\_\_\_\_

Printed Name: \_\_\_\_\_

LEAD TIME WILL START UPON RECEIPT OF SIGNED APPROVAL DRAWING

DISTRIBUTOR'S NAME:		P.O.#
VESTIL MANUFACTURING		X
DRAWN BY: B.HORN		W.O.#
DATE: 07/22/14		X
REFERENCE: X	SCALE: 1:15	SALES: X
QUOTED LEAD TIME: X	QUOTE # X	FILE NAME: 16-007-111