

SWIVEL DOCK GATE: SDG-9

*** ANY ADDITIONS, DELETIONS, OR OMISSIONS MUST BE CORRECTED ON THIS DRAWING AS THIS DRAWING WILL BE CONSIDERED ALL INCLUSIVE ***

ALL GRAPHICS PROVIDED ARE FOR REFERENCE ONLY. IF CERTAIN DIMENSIONS ARE CRITICAL PLEASE VERIFY THOSE DIMENSIONS WITH YOUR SALESPERSON

APPROX WEIGHT: 155.14 lbs.
DOES NOT INCLUDE WEIGHT OF POWER OR PACKAGING!!!

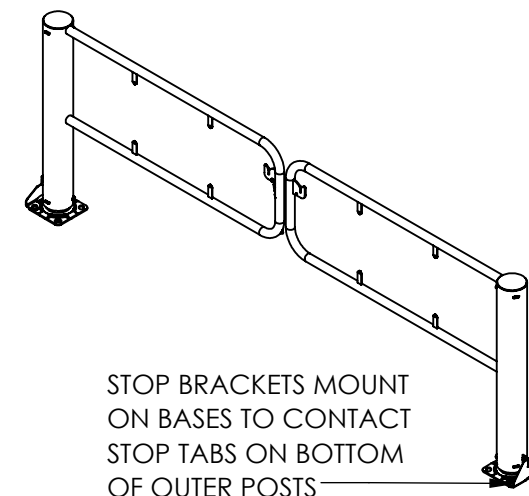
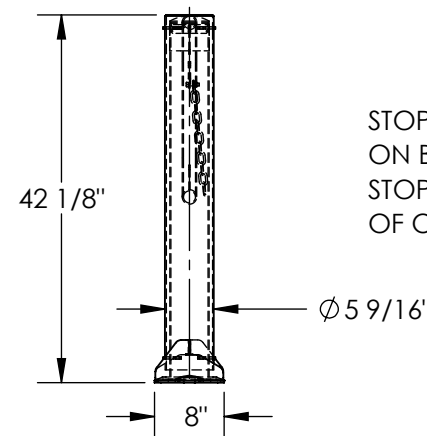
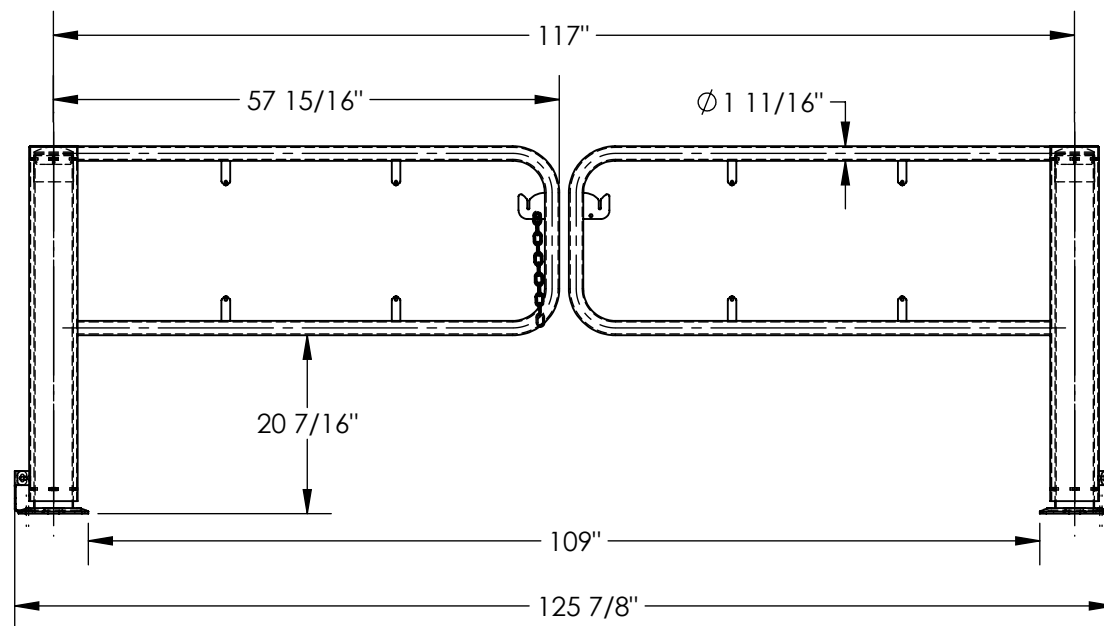

STOP BRACKETS MOUNT
ON BASES TO CONTACT
STOP TABS ON BOTTOM
OF OUTER POSTS

STANDARD FEATURES

MODEL NUMBER: SDG-9
OVERALL WIDTH: 125 7/8"
INNER WIDTH: 109"
OVERALL HEIGHT: 42 1/8"
OVERALL DEPTH: 8"
LAG DOWN MOUNTING PLATES: 5/8" x 8" x 8"
WITH (4) Ø7/8" x 1 1/4" MOUNTING SLOTS
FOR Ø3/4" ANCHOR BOLTS (SOLD SEPARATELY)
RIGHT AND LEFT GATES CLOSE AND LATCH WITH CHAIN
SWINGS MANUALLY UP TO 355°
STEEL CONSTRUCTION
DURABLE BAKED IN POWDER COATED YELLOW FINISH

SPECIAL FEATURES

NONE

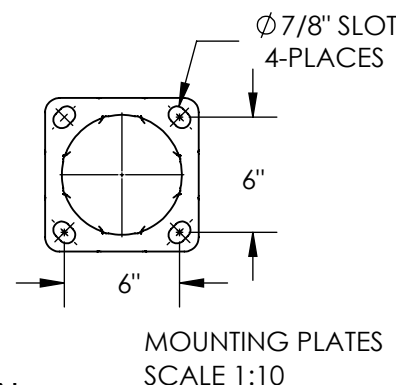

DIMENSION TOLERANCE $\pm 1/4$ "

APPROVAL

I, THE UNDERSIGNED, AGREE THAT THE PRODUCT AS REPRESENTED SATISFIES DESIGN AND DIMENSION REQUIREMENTS. I ALSO ACKNOWLEDGE MY DUTY TO CONFIRM PRODUCT AND INSTALLATION COMPLIANCE WITH ALL APPLICABLE FEDERAL, STATE AND LOCAL REGULATIONS AND STANDARDS.
UNITS REQUIRING APPROVAL DRAWINGS OR MODIFIED ARE NON-RETURNABLE
[] As drawn [] As marked

Signed: _____ Date: _____

Printed Name: _____

LEAD TIME WILL START UPON RECEIPT OF SIGNED APPROVAL DRAWING

DISTRIBUTOR'S NAME:		P.O.#
VESTIL MANUFACTURING		X
DRAWN BY:	DATE:	W.O.#
RAL	06/24/14	X
REFERENCE:	SCALE:	SALES:
X	1:22	X
QUOTED LEAD TIME:	QUOTE #	FILE NAME:
X	X	23-007-520