

EXTRA TRAVEL TRI-POST JIB - TJIB-20

APPROX WEIGHT: 297.95 lbs.
DOES NOT INCLUDE WEIGHT OF POWER OR PACKAGING!!!

*** ANY ADDITIONS, DELETIONS, OR OMISSIONS MUST BE CORRECTED ON THIS DRAWING AS THIS DRAWING WILL BE CONSIDERED ALL INCLUSIVE ***

ALL GRAPHICS PROVIDED ARE FOR REFERENCE ONLY. IF CERTAIN DIMENSIONS ARE CRITICAL PLEASE VERIFY THOSE DIMENSIONS WITH YOUR SALESPERSON

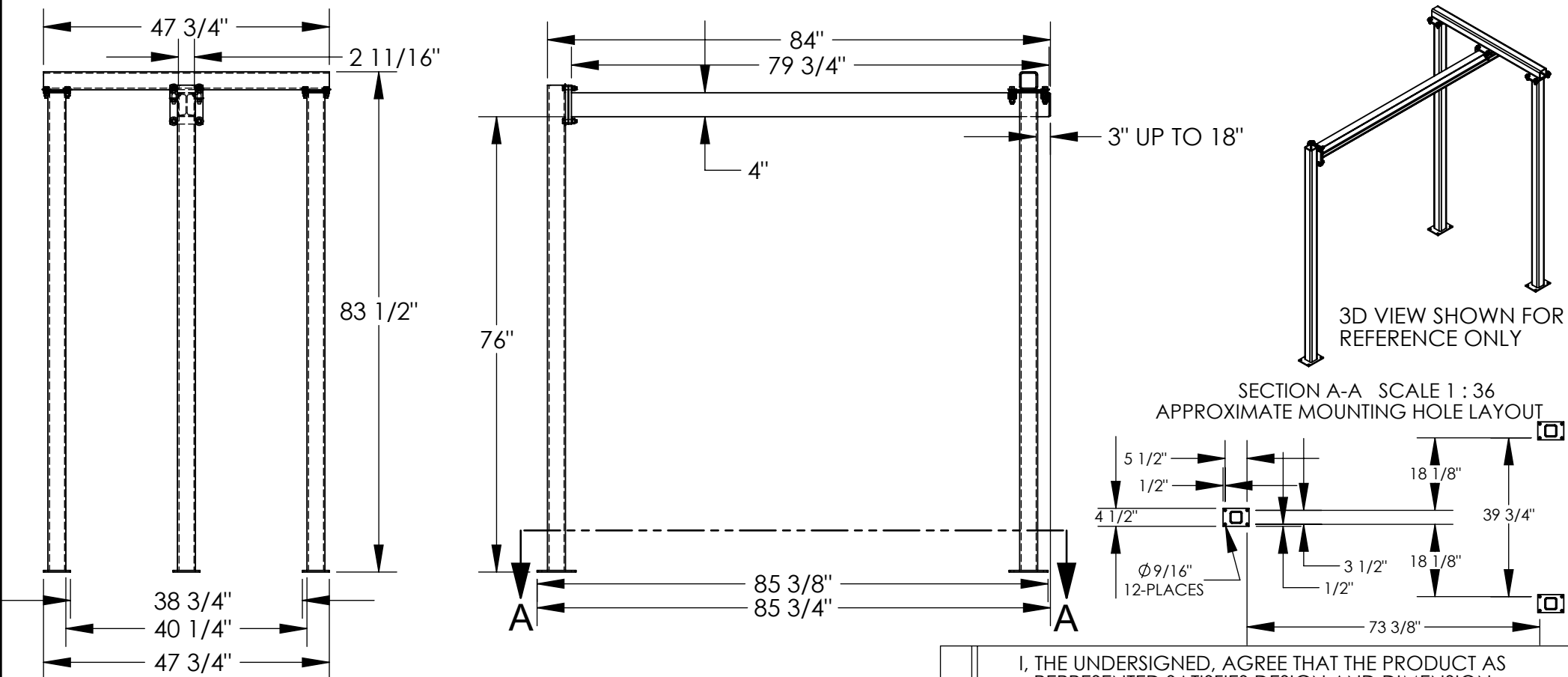

STANDARD FEATURES

MODEL NUMBER IS TJIB-20
CAPACITY IS 2000 LBS.
OVERALL WIDTH IS 47 3/4"
STRADDLE WIDTH (ID) IS 40 1/4"
OVERALL LENGTH IS 85 3/4"
USABLE I-BEAM LENGTH IS 79 3/4"
OVERALL HEIGHT IS 83 1/2"
UNDER I-BEAM CLEARANCE IS 76"
I-BEAM SIZE IS 4" HEIGHT X 2 11/16" FLANGE WIDTH
OVERHANG OF I-BEAM CAN BE SET FROM 3" UP TO 18"
DURABLE LIQUID PAINT BLUE FINISH

SPECIAL FEATURES

NONE

NOTE:

SPECIAL FOUNDATION MAY
BE REQUIRED: SEE OWNERS
MANUAL FOR DETAILS

DIMENSION TOLERANCE $\pm 1/4"$

APPROVAL

I, THE UNDERSIGNED, AGREE THAT THE PRODUCT AS
REPRESENTED SATISFIES DESIGN AND DIMENSION
REQUIREMENTS. I ALSO ACKNOWLEDGE MY DUTY TO
CONFIRM PRODUCT AND INSTALLATION
COMPLIANCE WITH ALL APPLICABLE FEDERAL, STATE
AND LOCAL REGULATIONS AND STANDARDS.
**UNITS REQUIRING APPROVAL DRAWINGS OR
MODIFIED ARE NON-RETURNABLE**

[] As drawn [] As marked

Signed: _____ Date: _____

Printed Name: _____

LEAD TIME WILL START UPON RECEIPT OF SIGNED APPROVAL DRAWING

DISTRIBUTOR'S NAME:		P.O.#
VESTIL MANUFACTURING		X
W.O.#		X
DRAWN BY: ND	DATE: 2/9/2013	SALES: X
REFERENCE: X	SCALE: 1:24	FILE NAME:
QUOTED LEAD TIME: X	QUOTE # X	28-007-041