

APPROX WEIGHT: 38.70 lbs.  
DOES NOT INCLUDE WEIGHT OF POWER OR PACKAGING!!!

# STEEL RAILING 84 IN POUR IN PLACE: VDKR-PP-7

\*\*\* ANY ADDITIONS, DELETIONS, OR OMISSIONS MUST BE CORRECTED ON THIS DRAWING AS THIS DRAWING WILL BE CONSIDERED ALL INCLUSIVE \*\*\*  
ALL GRAPHICS PROVIDED ARE FOR REFERENCE ONLY. IF CERTAIN DIMENSIONS ARE CRITICAL PLEASE VERIFY THOSE DIMENSIONS WITH YOUR SALESPERSON

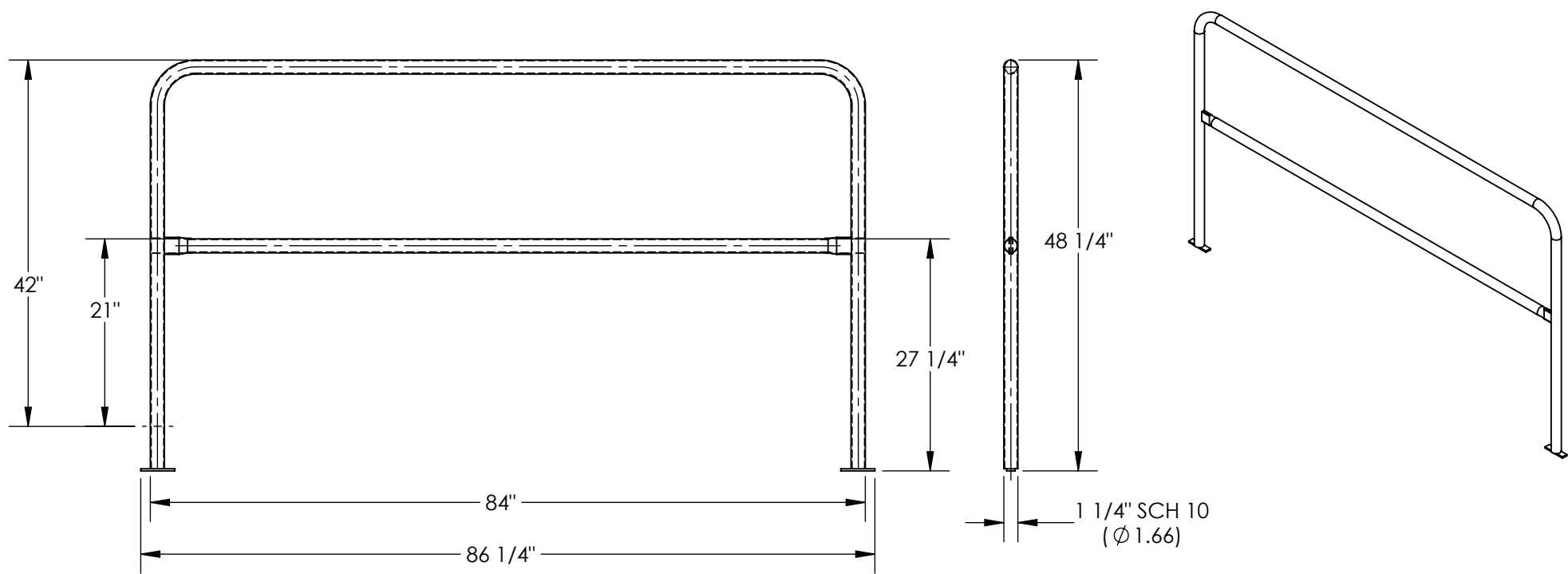

DIMENSION TOLERANCE ± 1/4"

## STANDARD FEATURES

MODEL NUMBER: VDKR-PP-7  
USABLE HEIGHT: 42"  
OVERALL HEIGHT: 48 1/4"  
USABLE MID RAIL HEIGHT: 21"  
OVERALL MID RAIL HEIGHT: 27 1/4"  
USABLE LENGTH: 84"  
OVERALL LENGTH: 86 1/4"  
HANDRAIL DIAMETER: Ø1 5/8"  
DURABLE BAKED IN POWDER  
COAT YELLOW FINISH

## SPECIAL FEATURES

NONE

APPROVAL

I, THE UNDERSIGNED, AGREE THAT THE PRODUCT AS REPRESENTED SATISFIES DESIGN AND DIMENSION REQUIREMENTS. I ALSO ACKNOWLEDGE MY DUTY TO CONFIRM PRODUCT AND INSTALLATION COMPLIANCE WITH ALL APPLICABLE FEDERAL, STATE AND LOCAL REGULATIONS AND STANDARDS.  
**UNITS REQUIRING APPROVAL DRAWINGS OR MODIFIED ARE NON-RETURNABLE**  
[ ] As drawn [ ] As marked

Signed: \_\_\_\_\_ Date: \_\_\_\_\_

Printed Name: \_\_\_\_\_

LEAD TIME WILL START UPON RECEIPT OF SIGNED APPROVAL DRAWING

|                      |     |            |            |
|----------------------|-----|------------|------------|
| DISTRIBUTOR'S NAME:  |     | P.O.#      | X          |
| VESTIL MANUFACTURING |     | W.O.#      | X          |
| DRAWN BY:            | EAG | DATE:      | 6/2/2025   |
| REFERENCE:           | X   | SCALE:     | 1:18       |
| QUOTED LEAD TIME:    | X   | QUOTE #    | X          |
|                      |     | SALES:     | X          |
|                      |     | FILE NAME: | 23-007-927 |