

SEMI LIVE SKI LEGS - VHPT-SL-LEG-30

APPROX WEIGHT: 10.58 lbs.
DOES NOT INCLUDE WEIGHT OF POWER OR PACKAGING!!!

*** ANY ADDITIONS, DELETIONS, OR OMISSIONS MUST BE CORRECTED ON THIS DRAWING AS THIS DRAWING WILL BE CONSIDERED ALL INCLUSIVE ***

ALL GRAPHICS PROVIDED ARE FOR REFERENCE ONLY. IF CERTAIN DIMENSIONS ARE CRITICAL PLEASE VERIFY THOSE DIMENSIONS WITH YOUR SALESPERSON

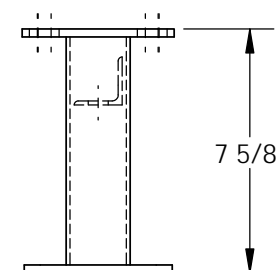
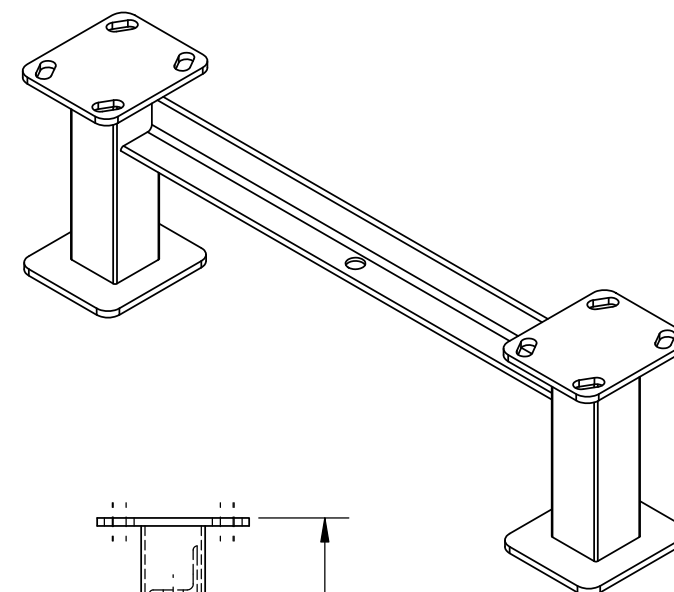
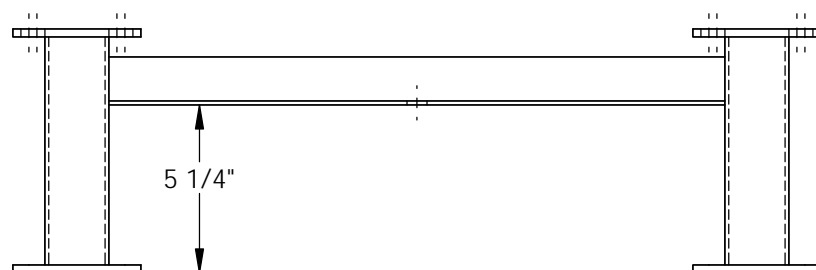
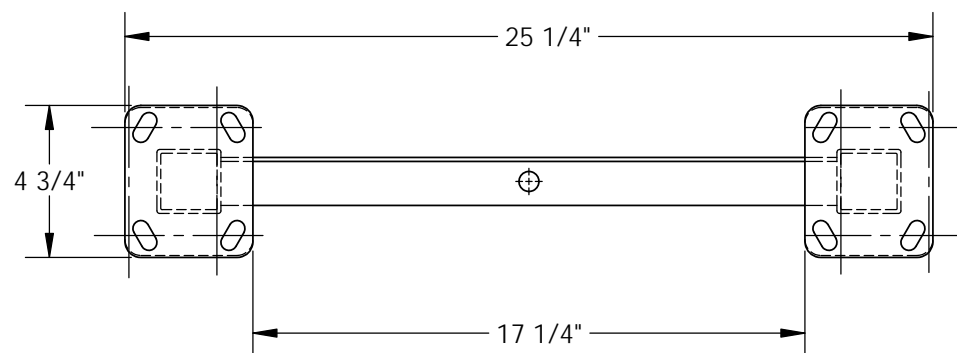

DIMENSION TOLERANCE $\pm 1/4"$

STANDARD FEATURES

MODEL NUMBER IS VHPT-SL-LEG-30
OVERALL WIDTH IS 25 1/4"
OVERALL DEPTH IS 4 3/4"
OVERALL HEIGHT IS 7 5/8"
FOR USE ON VHPT HARDWOOD PLATFORM TRUCKS
USED IN CONJUNCTION WITH VHPT-JACK, SEMI LIVE LEVER JACK
POWDERCOAT FINISH
UNIT ATTACHES TO EXISTING CASTER MOUNTING HOLES

SPECIAL FEATURES

NONE

APPROVAL

I, THE UNDERSIGNED, AGREE THAT THE PRODUCT AS REPRESENTED SATISFIES DESIGN AND DIMENSION REQUIREMENTS. I ALSO ACKNOWLEDGE MY DUTY TO CONFIRM PRODUCT AND INSTALLATION COMPLIANCE WITH ALL APPLICABLE FEDERAL, STATE AND LOCAL REGULATIONS AND STANDARDS.
ALL SPECIAL UNITS ARE NON-RETURNABLE
[] As drawn [] As marked

Signed: _____ Date: _____

LEAD TIME WILL START UPON RECEIPT OF SIGNED APPROVAL DRAWING

FOR INTERNAL USE ONLY
PROJECT SIGN OFF

SALES	
ENG.	
FAB.	
POWER	

DISTRIBUTOR'S NAME:

VESTIL MANUFACTURING

DRAWN BY: TJM

DATE: 12/07/11

REFERENCE: X

SCALE: 1:6

QUOTED LEAD TIME: X

QUOTE # X

P.O.#

X

W.O.#

X

SALES: X

FILE NAME:

33-007-235