



**Vestil Manufacturing Corp.**  
 2999 North Wayne Street, P.O. Box 507, Angola, IN 46703  
 Telephone: (260) 665-7586 -or- Toll Free (800) 348-0868  
 Fax: (260) 665-1339  
 Web: [www.vestilmfg.com](http://www.vestilmfg.com) E-mail: [info@vestil.com](mailto:info@vestil.com)

## CYL-HLT series Cylinder Transporter Instruction Manual



**Receiving Instructions**

After delivery, remove the packaging from the product. Inspect the product closely to determine whether it sustained damage during transport. If damage is discovered, record a complete description of it on the bill of lading. If the product is undamaged, discard the packaging.

**Replacement Parts and Technical Service**

For answers to questions not addressed in these instructions and to order replacement parts, labels, and accessories, call our Technical Service and Parts Department at (260) 665-7586. The department can also be contacted online at [http://www.vestilmfg.com/parts\\_info.htm](http://www.vestilmfg.com/parts_info.htm).

NOTE: The end-user is solely responsible for confirming that product design, use, and maintenance comply with laws, regulations, codes, and mandatory standards applied where the product is used.

**Table of Contents**

Specifications.....	2
Signal Words.....	3
Hazards.....	3
Exploded View & Bill of Materials.....	4
Using the Lifter.....	5
Record of Satisfactory Condition.....	6
Inspections & Maintenance.....	6
Labeling Diagram.....	6
Limited Warranty.....	7

# SPECIFICATIONS

Dimensions, net weight, and capacity information are provided in the following diagrams.

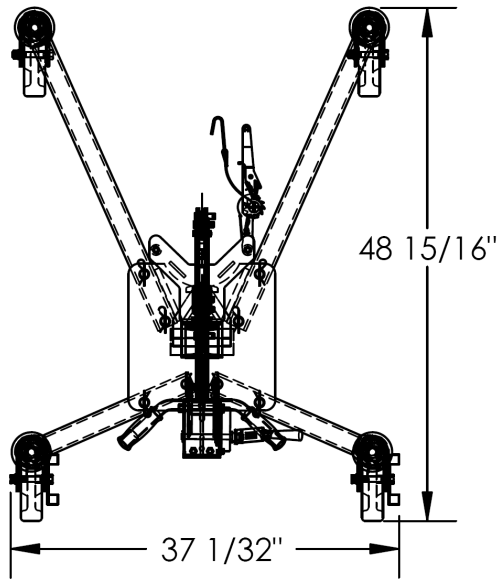

APPROXIMATE NET WEIGHT = 274 lb. (124.5kg)

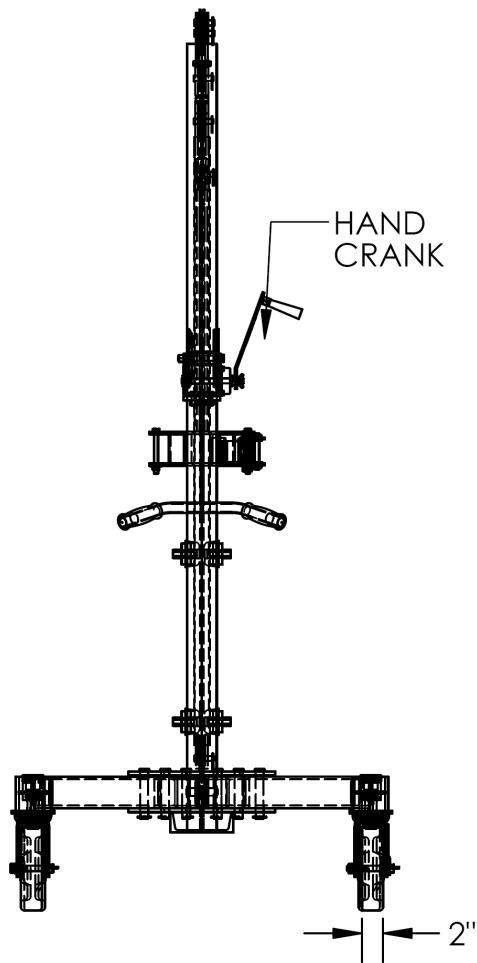
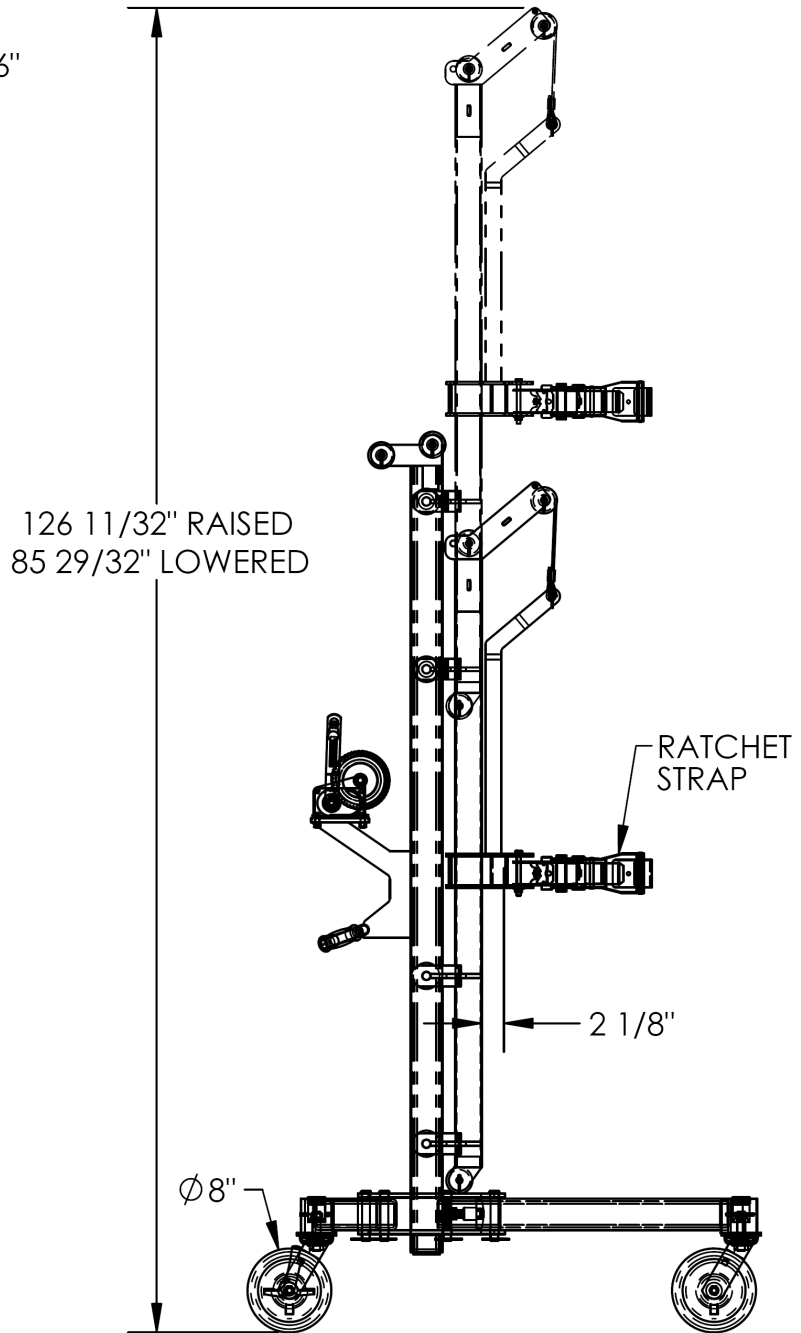

## SIGNAL WORDS

This manual uses SIGNAL WORDS to direct the reader's attention to statements about uses of the product that could result in personal injury or property damage. Each signal word correlates with a specific level of seriousness.



Identifies a hazardous situation which, if not avoided, **WILL** result in DEATH or SERIOUS INJURY. Use of this signal word is limited to the most extreme situations.



Identifies a hazardous situation which, if not avoided, **COULD** result in DEATH or SERIOUS INJURY.



Indicates a hazardous situation which, if not avoided, **COULD** result in MINOR or MODERATE injury.



Identifies practices likely to result in product/property damage, such as operation that might damage the product.

## HAZARDS

Vestil strives to identify all hazards associated with the use of this product. However, material handling is dangerous and no manual can address every conceivable risk. The most effective means for preventing injury is for the end-user to exercise good judgment whenever using this device.



Material handling is dangerous. Serious personal injuries might result if this product is used improperly or carelessly.

- **Read and understand the entire manual before using or servicing the product.** Read the manual to refresh your understanding of proper use, inspection, and maintenance procedures whenever necessary.
- DO NOT exceed the maximum rated load.
- Inspect the lifter as instructed in [Inspections & Maintenance](#) on p. 6. DO NOT use the product unless or until it is in satisfactory condition. ONLY use manufacturer-approved replacement parts.
- Contact [Technical Service](#) to discuss any questions you have regarding using, inspecting, or maintaining this product.
- DO NOT use the lifter to transport any cylinder that does not seat securely in the bracket. For instance, if the diameter of a cylinder is too large, the cylinder will not fit into the bracket. Cylinders must seat into the bracket as described in [Using the Lifter. Step 3](#) on p. 5
- DO NOT transport a cylinder unless it is securely held by the ratchet strap. The cylinder should not be able to slide through the strap.
- ONLY raise cylinders a few inches above the floor when transporting them. DO NOT move the lifter up or down sloped ground. If you must traverse sloped ground, always remain uphill of the lifter.
- Although the CYL-HLT is equipped with 2 locking casters, these locks will NOT hold the lifter in place on an incline and will not stop the lifter as it rolls downhill. DO NOT park the lifter on inclined ground. Only park the lifter on even, level ground. Apply both caster brakes whenever the lifter is not in use.
- DO NOT leave a raised cylinder unattended.
- DO NOT store cylinders on the lifter.
- DO NOT remove or obscure any label. All labels must be undamaged and easily readable. See [Labeling Diagram](#) on p. 6.
- DO NOT modify the lifter in any way without express, written approval from Vestil. Unapproved modifications automatically void the [Limited Warranty](#) (see p. 7) and might make the lifter unsafe to use.

# EXPLODED VIEW AND BILL OF MATERIALS

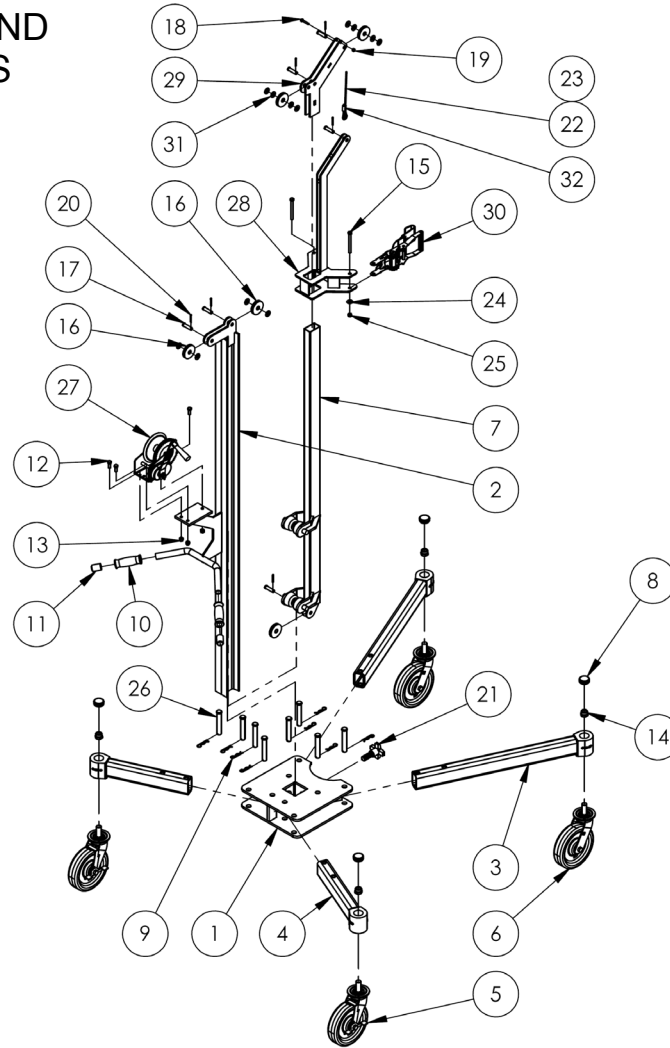

Item	Part no.	Description	Qty.	Item	Part no.	Description	Qty.
1	42-514-022	Weldment, base	1	17	21-112-003	Pin, 1/2" x 1 15/16" retaining clevis	6
2	42-514-027	Weldment, center column	1	18	11009	Hex bolt, gr. A, zinc plated, 1/4"-20 x 1 1/2"	1
3	42-514-024	Weldment, leg, front	2	19	37018	Lock nut, gr. 2, zinc finish, 1/4"-20	1
4	42-514-025	Weldment, leg, back	2	20	65078	Extended prong cotter pin, zinc finish, 1/8" x 1 1/2"	6
5	16-132-204	Stem caster, PH-8/2-S-SWB-ST	2	21	08-025-004	X-handle, locking bolt	1
6	16-132-181	Stem caster, PH-F-8/2-S-STM	2	22	42-145-004	Aircraft cable, 3/16", 180" long	1
7	42-514-028	Weldment, roller column	1	23	21-145-013	Thimble	1
8	99-024-003	Guard/cover/end cap/plug	4	24	33008	Flat washer, low carbon, USS, zinc plated, 3/8"	2
9	45283	Pin clip, bridge, zinc plated, 0.093" x 2 5/16"	8	25	36106	Hex nut, gr. A, zinc plated, 3/8"-16	2
10	15-025-006	Grip, handle	2	26	28-112-031	Clevis pin, 3/4" x 4 1/2"	8
11	21-024-038	Handle, grip, flexible vinyl, round cap	2	27	21-042-002-001	Hand winch, 1-piece, straight handle grip	1
12	11105	Hex bolt, gr. A, zinc plated, 3/8"-16 x 1"	3	28	16-514-134	Weldment, strap height adjuster	1
13	37024	Lock nut, gr. 2, zinc finish, 3/8"-16	3	29	16-527-008	Weldment, pulley assembly	1
14	37039	Nylock nut, zinc plated, 3/4"-10	4	30	30-001-246	Strap, dual ratchet strap	1
15	11119	Hex bolt, gr. A, zinc finish, 3/8"-16 x 4"	2	31	33086	Flat washer, zinc plated, SAE, 1/2" x 1.062"OD	12
16	99-027-005	Pulley, 3/16", cable, 2 1/2"OD, 1/2"ID	5	32	99-145-067	Compression sleeve, 3/16" x 1"	1

## USING THE LIFTER

The lifter should only be used on even, level surfaces. Push the lifter rather than pulling it. Do not use the lifter to transport cylinders across sloped ground unless you are certain that you can easily control it. Control the lifter from the uphill side.

1. Use the winch to adjust the position of the cylinder receiver. The top of the cylinder should be close to the angled arm of the receiver. Turn the winch handle clockwise to raise the receiver. Turn the handle counterclockwise to lower the receiver.
2. Disconnect the J-hook at the end of the ratchet strap from the hook bolt/pin.
3. Move the lifter into position so that the front legs straddle the cylinder. The cylinder must seat into the cylinder bracket, i.e. it should touch the inside of the bracket in at least 2 places. If a cylinder is too wide (diameter is too large), it will not seat into the bracket. Do not attempt to lift or transport cylinders that are too wide to properly seat into the bracket.
4. Unroll enough strap to wrap around the cylinder. Extend the strap by pulling the ratchet release toward the handle and pivoting the handle approximately 180 degrees. The handle will be in the position shown in the *Detail view*. Pull the strap now to unwind it from the spindle. Let go of the release lever when there is enough strap to wrap around the cylinder.
5. Wrap the ratchet strap around the cylinder. Connect the J-hook to the hook bolt/pin.
6. Move the handle back-and-forth to tighten the strap against the cylinder. If the strap is too loose, the cylinder will slide when the receiver is raised. Tighten the strap until it becomes difficult to move the handle.
7. Raise the cylinder a few inches off of the ground by turning the winch handle clockwise.
8. Transport the cylinder to the desired location.
9. Lower the cylinder to rest on the ground. Be sure that it is stable; then release strap tension. The strap release process is described in step 4.

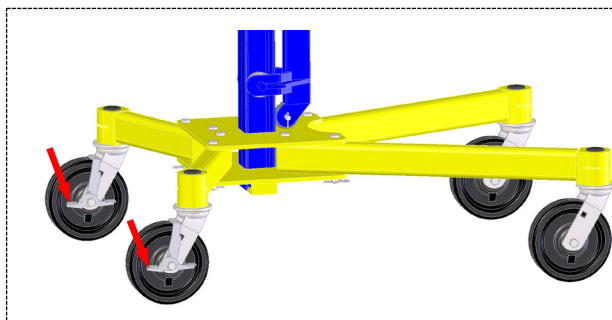
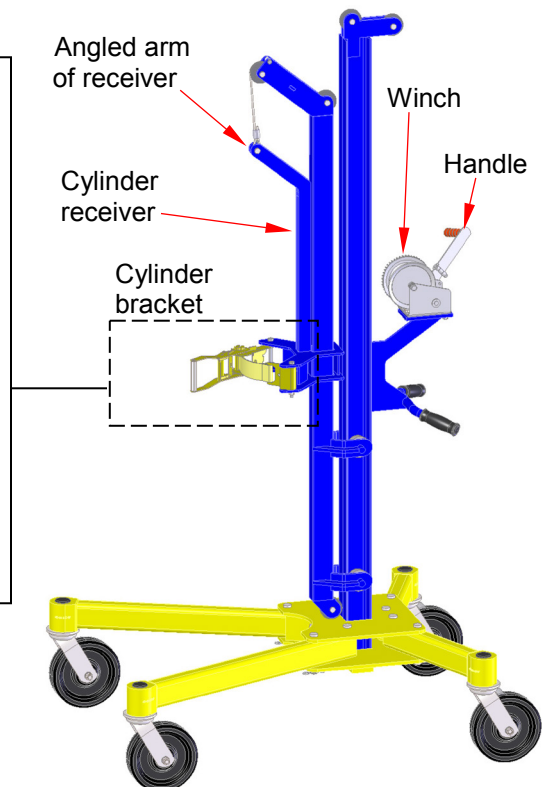
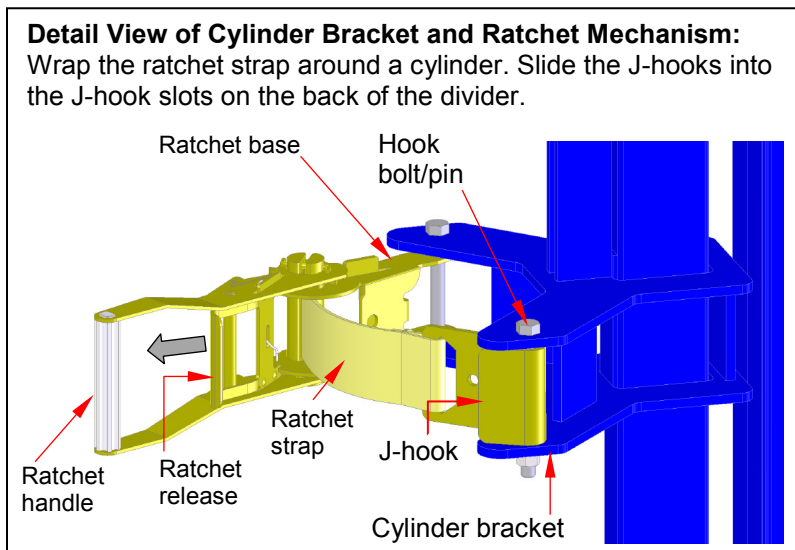

**NOTE:** Both rear casters have brakes. Apply the brakes by pressing down on the brake levers. Brake levers are identified with red arrows in the diagram. Press down on the levers until the brakes firmly contact the casters. Lift the levers to release the brakes.

These brakes are intended to impede movement when the lifter is *already* stopped. The brakes should not be used to bring the lifter to a stop. The brakes will not prevent the lifter from rolling downhill.

## RECORD OF SATISFACTORY CONDITION (THE “RECORD”)

Record the condition of the lifter before putting it into service. Thoroughly photograph the unit from multiple angles so that all fasteners and operating mechanisms are clearly visible. Take close range photographs of the labeling applied to the truck. Raise and lower a cylinder. Describe the operation of the winch. Describe sounds heard as the cylinder rises and descends. Include detailed descriptions of the frame, rollers, casters, carriage, mast rollers, and the lifting mechanisms (winch, cable, and sheaves). How much effort is required to turn the winch? Apply the caster brakes. Photograph the brakes. Try to move the truck with the brakes applied and describe how well the brakes resist movement. Collate all photographs and writings into a single file. Give the file a name that clearly identifies it. This file is a record of the unit in satisfactory condition. Compare the findings of all inspections to the record to determine whether the truck is in satisfactory condition. Purely cosmetic changes, like damaged paint/powder coat are not changes from satisfactory condition. However, touch-up paint to be applied to all affected areas as soon as damage occurs.

## INSPECTIONS & MAINTENANCE

Regular inspections and maintenance are necessary to keep the device in normal condition. Compare the results of each inspection to the *Record* to determine whether the unit is satisfactory condition or requires repairs or replacement parts. If you are uncertain whether a part requires repair or replacement, contact *Technical Service* to discuss your concerns.

- Periodically lubricate moving parts.
- Keep the product clean and dry.
- Only use manufacturer-approved replacement parts.

Inspect the lifter at least once per month to confirm satisfactory condition. Do not return the lifter to service unless/until it is in satisfactory condition.

- 1) Examine the frame for cracked welds, metal fatigue, rust, and corrosion that affects the structural integrity of the lifter. The structure should be clean, square and rigid, and free of rust and corrosion. Remove dirt and debris.
- 2) Inspect the winch and cable. Sheaves should turn smoothly as the cable passes over them. The cable should be free of elongations, bird-caging, thinning, broken/cut strands, and rust and corrosion. The winch should turn smoothly in both directions. It should be solidly fastened to the frame of the lifter.
- 3) Check the ratchet mechanism and ratchet strap. Release/extend the strap. See *Step 4* on p. 5. Move the handle back-and-forth to retract/tighten the strap. You should not be able to pull strap from the spindle unless the ratchet has been released. The strap must not be cut, substantially worn, fraying, etc.
- 4) Inspect the casters. Move the lifter a short distance to confirm that each caster rolls smoothly and is securely fastened to the lifter. The wheel material should not be cracked, severely or unevenly worn, or damaged in other ways that affect its ability to support weight or roll easily.
- 5) Labels: confirm that all labels are present, undamaged and readable. See *Labeling diagram* (below).

## LABELING DIAGRAM

The unit should be labeled as shown in the diagram. However, label content and location are subject to change so your product might not be labeled exactly as shown. Thoroughly photograph the unit when you first receive it as discussed in the *Record of Satisfactory Condition* section of this manual. Make sure that your Record includes a photograph of each label. Modify this diagram, if necessary, to indicate labeling actually applied. Replace all labels that are, damaged, missing, or not easily readable (e.g. faded). Contact the *Parts Department* online at [http://www.vestilmfg.com/parts\\_info.htm](http://www.vestilmfg.com/parts_info.htm) to order replacement labels. You may also call (260) 665-7586 and ask the operator to connect you to the *Parts Department*.

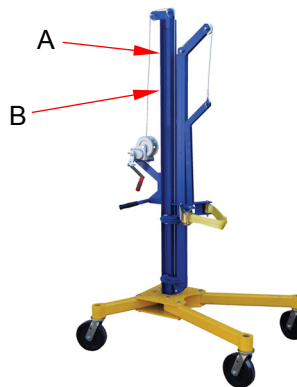

### B: Label 287

MODEL/MODÉLO/MODÈLE	_____
STATIC CAPACITY (evenly distributed)	_____ lbs.
LA CAPACIDAD CONSTANTE (distribuida uniformemente)	_____ kgs.
CAPACITÉ STATIQUE (distribuée régulièrement)	_____ kgs.
SERIAL/SERIE/SÉRIE	_____

287 REV 0812

### A: Label 728

**⚠ WARNING**

Mishandling or careless handling of compressed gas cylinders might result in serious personal injuries.

- Inspect winch, cable, cylinder cradle, ratchet and strap for damage or excessive wear before each use.
- DO NOT use if damaged.
- DO NOT leave a raised cylinder unattended or attempt to transport a raised cylinder. Cylinder should rest firmly on lifter base.
- DO NOT store cylinders on lifter.
- To release ratchet, squeeze release lever and swing handle.

**⚠ AVISO**

El uso incorrecto o el manejo de los cilindros de gas comprimidos pueden resultar en daños personales severos.

- Inspeccione la llave, el cable, la cuna del cilindro, y amarres por daños o uso excesivos antes de usarlos.
- NO USE si está dañado.
- No deje el cilindro sin atención cuando este en la posición elevada. El cilindro tiene que estar firme sobre la base del levantador.
- No almacene los cilindros en la levitador.
- Para soltar el agarre, oprima la palanca de agarre y menear la agaradera.

728

## LIMITED WARRANTY

Vestil Manufacturing Corporation (“Vestil”) warrants this product to be free of defects in material and workmanship during the warranty period. Our warranty obligation is to provide a replacement for a defective, original part covered by the warranty after we receive a proper request from the Warrantee (you) for warranty service.

### Who may request service?

Only a warrantee may request service. You are a warrantee if you purchased the product from Vestil or from an authorized distributor AND Vestil has been fully paid.

### Definition of “original part”?

An original part is a part used to make the product as shipped to the Warrantee.

### What is a “proper request”?

A request for warranty service is proper if Vestil receives: 1) a photocopy of the Customer Invoice that displays the shipping date; AND 2) a written request for warranty service including your name and phone number. Send requests by one of the following methods:

<u>US Mail</u>	<u>Fax</u>	<u>Email</u>
Vestil Manufacturing Corporation 2999 North Wayne Street, PO Box 507 Angola, IN 46703	(260) 665-1339 <u>Phone</u> (260) 665-7586	<a href="mailto:info@vestil.com">info@vestil.com</a> Enter “Warranty service request” in subject field.

In the written request, list the parts believed to be defective and include the address where replacements should be delivered. After Vestil receives your request for warranty service, an authorized representative will contact you to determine whether your claim is covered by the warranty. Before providing warranty service, Vestil will require you to send the entire product, or just the defective part (or parts), to its facility in Angola, IN.

### What is covered under the warranty?

The warranty covers defects in the following original, dynamic parts: motors, hydraulic pumps, motor controllers, and cylinders. It also covers defects in original parts that wear under normal usage conditions (“wearing parts”), such as bearings, hoses, wheels, seals, brushes, and batteries.

### How long is the warranty period?

The warranty period for original dynamic components is 90 days. For wearing parts, the warranty period is 90 days. Both warranty periods begin on the date Vestil ships the product to the Warrantee. If the product was purchased from an authorized distributor, the periods begin when the distributor ships the product. Vestil may, at its sole discretion, extend a warranty period for products shipped from authorized distributors by up to 30 days to account for shipping time.

### If a defective part is covered by the warranty, what will Vestil do to correct the problem?

Vestil will provide an appropriate replacement for any *covered* part. An authorized representative of Vestil will contact you to discuss your claim.

### What is not covered by the warranty?

The Warrantee (you) is responsible for paying labor costs and freight costs to return the product to Vestil for warranty service.

### Events that automatically void this Limited Warranty.

- Misuse;
- Negligent assembly, installation, operation or repair;
- Installation/use in corrosive environments;
- Inadequate or improper maintenance;
- Damage sustained during shipping;
- Collisions or other accidents that damage the product;
- Unauthorized modifications: Do not modify the product IN ANY WAY without first receiving written authorization from Vestil.

### Do any other warranties apply to the product?

Vestil Manufacturing Corp. makes no other express warranties. All implied warranties are disclaimed to the extent allowed by law. Any implied warranty not disclaimed is limited in scope to the terms of this Limited Warranty. Vestil makes no warranty or representation that this product complies with any state or local design, performance, or safety code or standard. Noncompliance with any such code or standard is not a defect in material or workmanship.

