

ECR	REV.	DESCRIPTION	DATE	INITIAL
A		UPDATED ITEM # 2.1, 2.2 & 2.3 STOCK SIZE ALSO UPDATED HOLES ON 2.1 & 2.3	07/01/10	GW

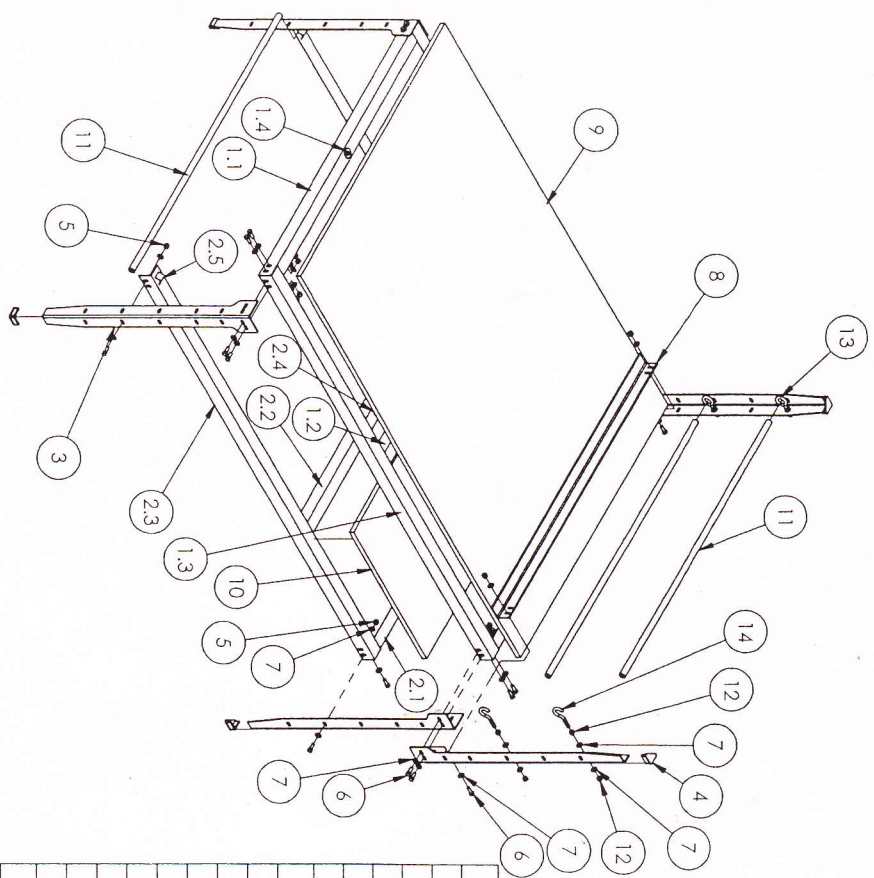

ITEM NO.	PART NUMBER	DESCRIPTION	STOCK SIZE	QTY.
1	43-014-012	ANGLE, END SUPPORT W/HOLES	1/8 X 2 X 2 X 48 1/4 LG STL ANGLE	2
1.1	43-014-012	ANGLE, END SUPPORT W/HOLES	1/8 X 2 X 2 X 48 1/4 LG STL ANGLE	2
1.2	43-014-008	ANGLE, MIDDLE SUPPORT	1/8 X 2 X 2 X 48 1/4 LG STL ANGLE	1
1.3	43-014-010	ANGLE, SIDE SUPPORT	1/8 X 2 X 2 X 72 1/2 LG STL ANGLE	2
1.4	33012	USS FLAT WASHER, Z PLATED, Ø1/2		3
2	43-014-010	WELDMENT, BOTTOM SHELF FRAME	1/8 X 2 X 2 X 48 1/4 LG STL ANGLE	1
2.1	43-014-012	ANGLE, END SUPPORT W/HOLES	1/8 X 2 X 2 X 48 1/4 LG STL ANGLE	1
2.2	43-014-008	ANGLE, MIDDLE SUPPORT	1/8 X 2 X 2 X 48 1/4 LG STL ANGLE	1
2.3	43-014-010	ANGLE, SIDE SUPPORT	1/8 X 2 X 2 X 72 1/2 LG STL ANGLE	2
2.4	33012	USS FLAT WASHER, Z PLATED, Ø1/2		2
2.5	43-014-010	BRACKET, TUBE HOLDER	1/8 X 1 X 1 X 1 LG STL ANGLE	2
3	43-014-009	FRAME, LEG, FORMED	10 GA. X 6" X 34 1/2" LG FLAT STL	6
4	43-024-004	PUSH-ON END CAP	1 1/2" X 1 1/2" X 3/4" TALL	6
5	37024	3/8 NYLOCK INSERT NUT		24
6	11105	BOLT, HHCS #2 Z PLATED, 3/8-16 x 1		24
7	33008	Ø3/8 USS FLAT WASHER Z PLATED		56
8	43-014-012	ANGLE, END SUPPORT W/HOLES	1/8 X 2 X 2 X 48 1/4 LG STL ANGLE	1
9	43-013-007	DECK, TOP SHELF	3/4" X 48" X 72" LG PARTICLE BOARD	1
10	43-013-006	DECK, BOTTOM SHELF	3/4" X 48" X 24" LG PARTICLE BOARD	3
11	43-014-011	TUBE, MATERIAL SUPPORT BAR	1/2" O.D. SCH 40 X 48 3/8" STL PIPE	8
12	36106	Hex Nut Z Plated, Ø 3/8 - 16		8
13	43-145-001	1" ID, 3/8-16 EYEBOLT ZINC PLATED	1" ID X 3 1/2" LG STL EYEBOLT	2
14	43-145-002	1" ID, 3/8-16 EYEBOLT W/CUT OUT TOP	1" ID X 3 1/2" LG STL EYEBOLT	2

Vestil Manufacturing Co. MODEL NO: MPPB-4794 DESCRIPTION: FINAL ASSY W/PARTS LIST DRAWN BY: Q. WESTFALL DWG NO: 43-008-007